

VALVOLE A SFERA

Ball Valves

CARATTERISTICHE TECNICO/COSTRUTTIVE GENERALI

• Materiali

- Corpo e manicotto: ottone UNI EN 12165-CW617N stampato a caldo
- Asta di manovra e premistoppa: UNI EN 12164-CW614N tornito
- Sfera: ottone UNI EN 12164-CW614N cromata lucida
- Maniglia: leva o farfalla in alluminio verniciato o leva in acciaio zincato o con guaina plastica. Colore standar rosso. Altri colori a richiesta
- Guarnizioni: NBR, HNBR, VITON, PTFE puro

• Tecnologia produttiva

- Stampaggio a caldo
- Lavorazioni meccaniche su macchine di precisione
- Montaggio su macchine automatiche
- Prova di tenuta al 100% su ogni prodotto

• Asta di manovra montata dall'interno non estraibile e antiscoppio

• Disponibili, secondo le serie, nei modelli a passaggio totale e passaggio ridotto, FF e MF, da 1/4" a 4"

• Tipi di filettature: ISO 228, ISO 7, NPT

• Fluidi di utilizzo ai fini della direttiva 97/23/CE (PED)

- gas combustibili (gruppo 1)
- vapore, aria (gruppo2)
- gasolio (gruppo2)
- acqua calda 110°C (gruppo2) e fluidi non aggressivi in genere

• Temperatura max 100°C (vedi diagramma "Pressione/Temperatura")

• Durante le lavorazioni tutti i particolari sono controllati secondo modalità definite nelle procedure del sistema qualità aziendale, certificato secondo la norma UNI EN ISO 9001:2008

• Molte serie (vedi titolazione accanto alla serie medesima) sono certificate da importanti Istituti Internazionali di certificazione di prodotto, i quali periodicamente mandano loro Ispettori a verificare il mantenimento degli standar normativi

Le caratteristiche e le misure sono indicative e non impegnano la BIANCHI F.LLI, che si riserva il diritto di apportare ai propri articoli, in qualunque momento e senza preavviso, modifiche tecniche o commerciali.



BIANCHI F.LLI S.p.a.
Rubinetteria

MADE IN ITALY
www.bianchifratelli.it



Finitura: ● Giallo/Yellow
Smooth: ● Cromo/Chrome
● Nichel/Nikel

L'ultima lettera del codice indica il tipo e il colore della maniglia

E Alluminio BLU
F Alluminio ROSSA
G Alluminio GIALLA
H Alluminio VERDE
M Alluminio NERA

A Ferro ROSSA
B Ferro GIALLA
C Ferro VERDE
D Ferro BLU
N Ferro NERA

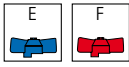

Valvola a sfera passaggio totale con bocchettone MM PN 40, maniglia a farfalla

Pipe union, male-male full bore ball valve PN 40 with T-handle

Válvula de bola con paso total PN 40, con tapón MM, manija de mariposa

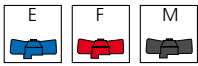

Valvola a sfera passaggio totale con bocchettone MF PN 40, maniglia a farfalla

Pipe union, male-female full bore ball valve PN 40 with T-handle

Válvula de bola con paso total PN 40, con tapón MH, manija de mariposa

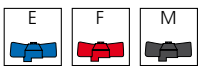

Valvola a sfera MF passaggio totale PN 40 con bocchettone pregiarrito, maniglia a farfalla

Pipe union and metal ring male-female full bore ball valve PN 40 with T-handle

Válvula de bola con paso total PN 40, con tapón MH y anillo metallico, manija de mariposa

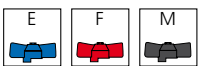

Valvola a sfera passaggio totale con bocchettone MF PN 25, maniglia a farfalla

Pipe union male-female full bore ball valve PN 25 with T-handle

Válvula de bola con paso total PN 25 con tapón MH manija de mariposa

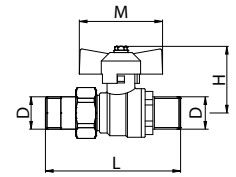

421

Code	Version	Size (D)	Smooth	€	D1	H	L	M	Pack
421000040_	E/F	1/2	●	7,73	-	42	85	54	12
421000050_	E/F	3/4	●	12,11	-	45	98	54	8
421000060_	E/F	1"	●	18,02	-	51	112	64	5

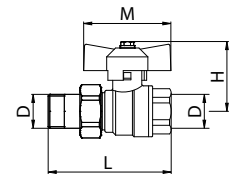

422

Code	Version	Size (D)	Smooth	€	D1	H	L	M	Pack
422000040_	E/F/M	1/2	●	7,48	-	42	77	54	12
422000050_	E/F/M	3/4	●	11,40	-	45	89	54	8
422000060_	E/F/M	1"	●	17,47	-	51	100	64	5

Disponibile con leva - Available with handle - Disponible con manija de palanca

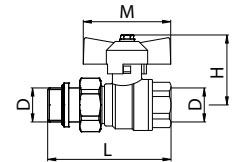

422A

Code	Version	Size (D)	Smooth	€	D1	H	L	M	Pack
422A00040_	E/F/M	1/2	●	7,98	-	42	80	54	12
422A00050_	E/F/M	3/4	●	12,17	-	45	87	54	8
422A00060_	E/F/M	1"	●	19,33	-	51	100	64	5

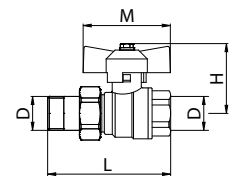

422B

Code	Version	Size (D)	Smooth	€	D1	H	L	M	Pack
422B00040_	E/F/M	1/2	●	6,77	-	42	80	54	12
422B00050_	E/F/M	3/4	●	9,67	-	45	87	54	8
422B00060_	E/F/M	1"	●	14,58	-	51	100	64	5
422B00070_	E/F/M	1" 1/4	●	24,72	-	54	126	70	4



Finitura: ● Giallo/Yellow
Smooth: ● Cromo/Chrome
● Nichel/Nikel

L'ultima lettera del codice indica il tipo e il colore della maniglia

E Alluminio BLU
F Alluminio ROSSA
G Alluminio GIALLA
H Alluminio VERDE
M Alluminio NERA
A Ferro ROSSA
B Ferro GIALLA
C Ferro VERDE
D Ferro BLU
N Ferro NERA

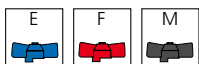

Valvola a sfera MF passaggio totale PN 25 con bocchettone preguarnito, maniglia a farfalla

Pipe union and metal ring male-female full bore ball valve PN 25 with T-handle

Válvula de bola con paso total PN 25 con tapón MH y anillo metálico, manija de mariposa

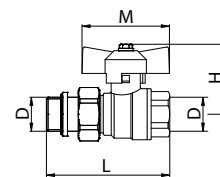

422BA

Code	Version	Size (D)	Smooth	€	D1	H	L	M	Pack
422BC004A_	E/F/M	1/2	●	7,53	-	42	80	54	12
422BC005A_	E/F/M	3/4	●	10,46	-	45	87	54	8
422BC006A_	E/F/M	1"	●	15,61	-	51	100	64	5
422BC007A_	E/F/M	1" 1/4	●	26,70	-	54	126	70	4

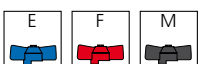

Valvola a sfera ad angolo con bocchettone preguarnito, maniglia a farfalla

Angle ball valve with pipe union, T-handle

Válvula de bola de esquadra con anillo metálico, manija de mariposa

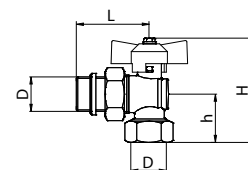

422R

Code	Version	Size (D)	Smooth	€	D1	H	L	h	Pack
422R00040_	E/F/M	1/2	●	10,05	-	78	36	55,5	-
422R00050_	E/F/M	3/4	●	13,84	-	83	65	39	8
422R00060_	E/F/M	1"	●	17,53	-	90	69	42,5	5

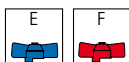

Valvola a sfera MF con bocchettone e termometro Ø 40mm, scala 0 - 80°C

Pipe union male-female brass ball valve with thermometer Ø 40mm, range 0 - 80°C

Válvula de bola para conexión al colector con termómetro Ø 40mm, de 0 - 80°C incorporado

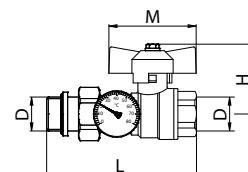

422M

Code	Version	Size (D)	Smooth	€	D1	H	L	M	Pack
422M00060_	E/F	1"	●	22,99	-	51	118	64	5
422MC0060_	E/F	1"	●	24,05	-	51	118	64	5
422M00070_	E/F	1" 1/4	●	33,89	-	54	164	70	2
422MC0070_	E/F	1" 1/4	●	35,45	-	54	164	70	2

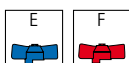

Valvola a sfera ad angolo con bocchettone preguarnito, termometro, maniglia a farfalla

Angle ball valve with pipe union, thermometer, T-handle

Válvula de bola de esquadra con anillo metálico, termómetro, manija de mariposa

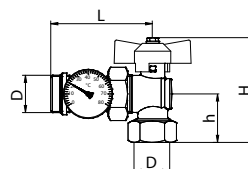

422RM

Code	Version	Size (D)	Smooth	€	D1	H	L	h	Pack
422RM0060_	E/F	1"	●	25,52	-	90	94	42,5	5



Finitura: ● Giallo/Yellow
Smooth: ● Cromo/Chrome
● Nichel/Nikel

L'ultima lettera del codice indica il tipo e il colore della maniglia

E Alluminio BLU
F Alluminio ROSSA
G Alluminio GIALLA
H Alluminio VERDE
M Alluminio NERA

A Ferro ROSSA
B Ferro GIALLA
C Ferro VERDE
D Ferro BLU
N Ferro NERA

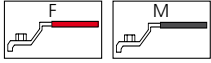

Valvola a sfera passaggio totale MF PN 40, maniglia a leva
Male-female full bore ball valve PN 40 with lever handle
Válvula de bola con paso total MH PN 40, manija de palanca

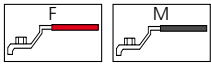

Valvola a sfera passaggio totale FF PN 40, maniglia a leva
Female-female full bore ball valve PN 40 with lever handle
Válvula de bola con paso total HH PN 40, manija de palanca

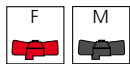

Valvola a sfera passaggio totale MF PN 40, maniglia a farfalla
Male-female full bore ball valve PN 40 with T-handle
Válvula de bola con paso total MH PN 40, manija de mariposa

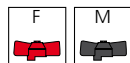

Valvola a sfera passaggio totale FF PN 40, maniglia a farfalla
Female-female full bore ball valve PN 40 with T-handle
Válvula de bola con paso total HH PN 40, manija de mariposa

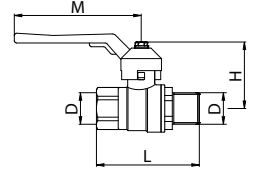

424

Code	Version	Size (D)	Smooth	€	D1	H	L	M	Pack
424000020A		1/4	●	5,48	-	38	53	81	12
424000030A		3/8	●	5,48	-	38	53	81	12
424000040_	F/M	1/2	●	6,21	-	49	65	84	12
424000050_	F/M	3/4	●	8,76	-	55	74	107	8
424000060_	F/M	1"	●	13,89	-	60	88	107	6
424000073_	F/M	1" 1/4	●	24,22	-	75	98	138	4
424000083_	F/M	1" 1/2	●	33,01	-	81	114	138	4
424000093_	F/M	2"	●	54,69	-	96	134	155	2

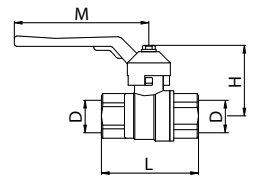

425

Code	Version	Size (D)	Smooth	€	D1	H	L	M	Pack
425000020_	A/M	1/4	●	5,18	-	38	46	81	12
425000030_	A/M	3/8	●	5,18	-	38	47	81	12
425000040_	F/M	1/2	●	5,99	-	49	60	84	12
425000050_	F/M	3/4	●	8,24	-	55	68	107	8
425000060_	F/M	1"	●	13,16	-	60	81	107	6
425000073_	F/M	1" 1/4	●	24,17	-	75	94	138	4
425000083_	F/M	1" 1/2	●	31,94	-	81	105	138	4
425000093_	F/M	2"	●	52,59	-	96	126	155	2
425000100F	10 bar max	2" 1/2	●	110,52	-	110	131	270	1
425000110F	10 bar max	3"	●	170,27	-	120	155	270	1
425000120F	10 bar max	4"	●	316,06	-	155	195	320	1

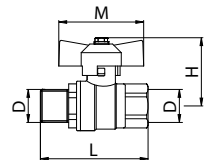

434

Code	Version	Size (D)	Smooth	€	D1	H	L	M	Pack
434000020F	-	1/4	●	5,48	-	35	53	43	12
434000030F	-	3/8	●	5,48	-	35	53	43	12
434000040_	F/M	1/2	●	6,21	-	42	65	54	12
434000050_	F/M	3/4	●	8,76	-	45	74	54	8
434000060_	F/M	1"	●	13,89	-	51	88	64	6

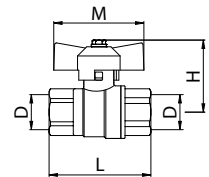

435

Code	Version	Size (D)	Smooth	€	D1	H	L	M	Pack
435000020F	-	1/4	●	5,18	-	35	47	43	12
435000030F	-	3/8	●	5,18	-	35	47	43	12
435000040_	F/M	1/2	●	5,99	-	42	61	54	12
435000050_	F/M	3/4	●	8,24	-	45	68	54	8
435000060_	F/M	1"	●	13,16	-	51	81	64	6



Finitura: ● Giallo/Yellow
Smooth: ● Cromo/Chrome
● Nichel/Nikel

L'ultima lettera del codice indica il tipo e il colore della maniglia

E Alluminio BLU
F Alluminio ROSSA
G Alluminio GIALLA
H Alluminio VERDE
M Alluminio NERA
A Ferro ROSSA
B Ferro GIALLA
C Ferro VERDE
D Ferro BLU
N Ferro NERA



Valvola a sfera passaggio totale MH PN 25 con maniglia a leva

Male-female full bore ball valve PN 25 with lever handle
Válvula de bola paso total MH PN 25 con manija de palanca

424B

Code	Version	Size (D)	Smooth	€	D1	H	L	M	Pack
424B00040A		1/2	●	4,57	-	52	51	93	12
424B00050A		3/4	●	6,55	-	57	61	93	10
424B00060A		1"	●	9,58	-	62	70	112	6
424B00070A		1" 1/4	●	17,50	-	66	91	112	6
424B00080A		1" 1/2	●	25,74	-	77	101	143	4
424B00090A		2"	●	40,03	-	81	117	143	2

Disponibile con leva in alluminio rossa (codice con finale F)
Available with red aluminium lever (code with F as final)

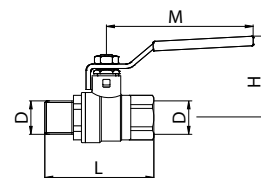

Valvola a sfera passaggio totale FF PN 25 con maniglia a leva

Female-female full bore ball valve PN 25 with lever handle
Válvula de bola con paso total HH PN 25 con manija de palanca

425B

Code	Version	Size (D)	Smooth	€	D1	H	L	M	Pack
425B00040A		1/2	●	4,63	-	52	50	93	12
425B00050A		3/4	●	6,12	-	57	56	93	10
425B00060A		1"	●	9,06	-	62	67	112	6
425B00070A		1" 1/4	●	16,81	-	66	84	112	6
425B00080A		1" 1/2	●	25,07	-	77	92	143	4
425B00090A		2"	●	38,94	-	81	106	143	4
425B00100A		2" 1/2	●	99,04	-	110	131	270	1
425B00110A		3"	●	136,21	-	120	150	270	1

Disponibile con leva in alluminio rossa (codice con finale F)
Available with red aluminium lever (code with F as final)

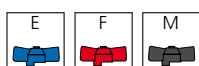
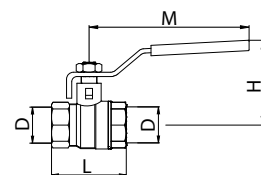

Valvola a sfera passaggio totale MF PN 25 con maniglia a farfalla

Male-female full bore ball valve PN 25 with T-handle
Válvula de bola paso total MH PN 25 con manija de mariposa

434B

Code	Version	Size (D)	Smooth	€	D1	H	L	M	Pack
434B00040_	E/F/M	1/2	●	4,57	-	42	51	54	20
434B00050_	E/F/M	3/4	●	6,55	-	45	61	54	15
434B00060_	E/F/M	1"	●	9,58	-	51	70	64	8

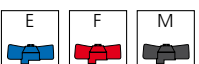
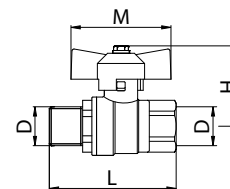

Valvola a sfera passaggio totale FF PN 25 con maniglia a farfalla

Female-female full bore ball valve PN 25 with T-handle
Válvula de bola paso total HH PN 25 con manija de mariposa

435B

Code	Version	Size (D)	Smooth	€	D1	H	L	M	Pack
435B00040_	E/F/M	1/2	●	4,63	-	42	50	54	20
435B00050_	E/F/M	3/4	●	6,12	-	45	56	54	15
435B00060_	E/F/M	1"	●	9,06	-	51	67	64	8

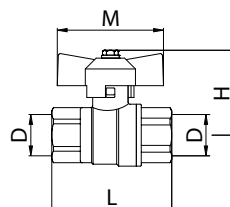



Valvola a sfera PN30 MF tipo export, passaggio totale, maniglia a leva

MF full bore ball valve PN30, export pattern with lever handle

Válvula de bola PN30 MH tipo export, paso total, manija de palanca



Valvola a sfera PN30 FF tipo export, passaggio totale, maniglia a leva

FF full bore ball valve PN30, export pattern with lever handle

Válvula de bola PN30 HH tipo export, paso total, manija de palanca



Valvola a sfera PN30 MF tipo export, passaggio totale, maniglia a T

MF full bore ball valve PN30, export pattern with T-handle

Válvula de bola PN30 MH tipo export, paso total, manija de mariposa



Valvola a sfera PN30 FF tipo export, passaggio totale, maniglia a T

FF full bore ball valve PN30, export pattern with T-handle

Válvula de bola PN30 HH tipo export, paso total, manija de mariposa

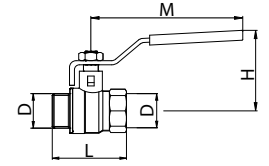

424A

Code	Version	Size (D)	Smooth	€	D1	H	L	M	Pack
424A00043M	-	1/2	●	4,88	-	52	54	93	12
424A00053M	-	3/4	●	7,06	-	57	66	93	10
424A00063M	-	1"	●	9,90	-	62	77	112	6
424A00073M	-	1" 1/4	●	17,91	-	66	91	112	6
424A00083M	-	1" 1/2	●	25,81	-	77	101	143	4
424A00093M	-	2"	●	40,02	-	81	117	143	2

Disponibile con leva in acciaio (codice con finale N)
Available with black iron lever (code with N as final)

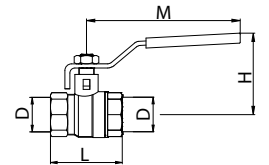

425A

Code	Version	Size (D)	Smooth	€	D1	H	L	M	Pack
425A00043M	-	1/2	●	5,10	-	52	57	93	12
425A00053M	-	3/4	●	6,79	-	57	63	93	10
425A00063M	-	1"	●	9,84	-	62	75	112	6
425A00073M	-	1" 1/4	●	17,11	-	66	84	112	6
425A00083M	-	1" 1/2	●	24,89	-	77	92	143	4
425A00093M	-	2"	●	39,09	-	81	106	143	4

Disponibile con leva in acciaio (codice con finale N)
Available with black iron lever (code with N as final)

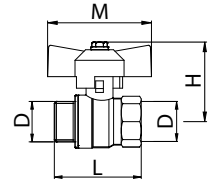

434A

Code	Version	Size (D)	Smooth	€	D1	H	L	M	Pack
434A00043M	-	1/2	●	4,88	-	42	54	54	20
434A00053M	-	3/4	●	7,06	-	45	66	54	15
434A00063M	-	1"	●	9,90	-	51	77	64	8

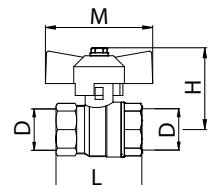

435A

Code	Version	Size (D)	Smooth	€	D1	H	L	M	Pack
435A00043M	-	1/2	●	5,10	-	42	57	54	20
435A00053M	-	3/4	●	6,79	-	45	63	54	15
435A00063M	-	1"	●	9,84	-	51	75	64	8

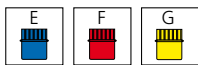

Valvola a sfera passaggio totale FF PN 40 con quadro

Female-female full bore ball valve PN 40 with square head

Válvula de bola paso total HH PN 40 con cabeza cuadrada

436

Code	Version	Size (D)	Smooth	€	D1	H	L	M	Pack
436000040_	E/F/G	1/2	●	6,29	-	42	54	15	12
436000050_	E/F/G	3/4	●	8,76	-	47	62	15	8
436000060_	E/F/G	1"	●	13,23	-	52	74	15	6
436000073_	E/F/G	1" 1/4	●	24,17	-	62	94	17	4

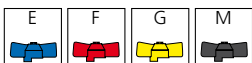
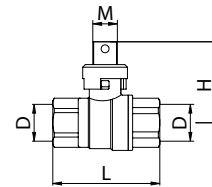

Valvola a sfera passaggio totale MM

Male-male full bore ball valve

Válvula de bola con paso total MM

423

Code	Version	Size (D)	Smooth	€	D1	H	L	M	Pack
423T00040_	E/F/G/M	1/2	●	6,12	-	42	62	54	15
423T00050_	E/F/G/M	3/4	●	7,82	-	45	70	54	8

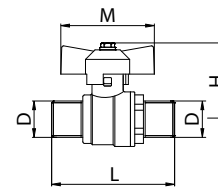

Valvola a sfera passaggio totale con spurgo, maniglia a leva

Full bore ball valve with drain and lever handle

Válvula de bola paso total con purga y manija de palanca

433

Code	Version	Size (D)	Smooth	€	D1	H	L	M	Pack
433000040F		1/2	●	9,76	-	49	58	84	20
433000050F		3/4	●	12,58	-	55	63	107	12
433000060F		1"	●	18,03	-	60	73	107	12
433000070F		1" 1/4	●	26,57	-	75	86	138	10
433000080F		1" 1/2	●	36,63	-	81	93	138	5
433000090F		2"	●	62,55	-	96	112	155	2

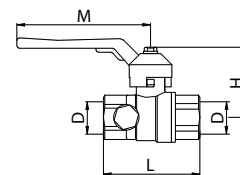

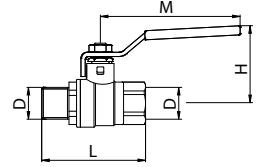

Valvola a sfera per gas passaggio totale MF PN 40, maniglia a leva
Male-female full bore gas ball valve PN 40 with lever handle
Válvula de bola para gas, paso total MH PN 40 con manija de palanca

424/2

Code	Version	Size (D)	Smooth	€	D1	H	L	M	Pack
424200023B		1/4	●	5,37	-	38	53	81	12
424200033B		3/8	●	5,37	-	38	53	81	12
424200043B		1/2	●	6,18	-	52	65	93	12
424200053B		3/4	●	8,70	-	58	74	112	8
424200063B		1"	●	13,71	-	63	88	112	6
424200073B		1" 1/4	●	24,01	-	73	98	143	4
424200083B		1" 1/2	●	33,13	-	79	114	143	4
424200093B		2"	●	54,46	-	95	134	162	2

A norma UNI EN 331

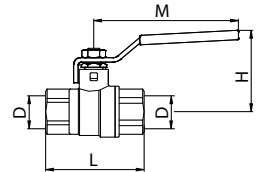

Valvola a sfera per gas passaggio totale FF PN 40, maniglia a leva
Female-female full bore gas ball valve PN 40 with lever handle
Válvula de bola para gas, paso total HH PN 40 con manija de palanca

425/2

Code	Version	Size (D)	Smooth	€	D1	H	L	M	Pack
425200020B		1/4	●	5,08	-	38	46	81	12
425200030B		3/8	●	5,08	-	38	47	81	12
425200043B		1/2	●	5,94	-	52	61	93	12
425200053B		3/4	●	8,41	-	58	68	112	8
425200063B		1"	●	13,17	-	63	81	112	6
425200073B		1" 1/4	●	23,33	-	73	94	143	4
425200083B		1" 1/2	●	31,49	-	79	105	143	4
425200093B		2"	●	52,34	-	95	126	162	2

A norma UNI EN 331

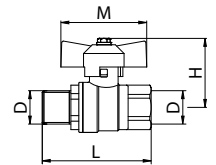

Valvola a sfera per gas passaggio totale MF PN 40, maniglia a farfalla
Male-female full bore gas ball valve PN 40 with T-handle
Válvula de bola para gas paso total MH PN 40, manija de mariposa

434/2

Code	Version	Size (D)	Smooth	€	D1	H	L	M	Pack
434200020G		1/4	●	5,37	-	35	53	43	12
434200030G		3/8	●	5,37	-	35	53	43	12
434200043G		1/2	●	6,18	-	42	65	54	12
434200053G		3/4	●	8,70	-	45	74	54	8
434200063G		1"	●	13,71	-	51	88	64	6

A norma UNI EN 331

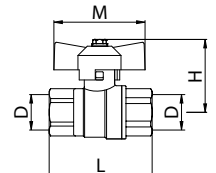

Valvola a sfera per gas passaggio totale FF PN 40, maniglia a farfalla
Female-female full bore gas ball valve PN 40 with T-handle
Válvula de bola para gas paso total HH PN 40, manija de mariposa

435/2

Code	Version	Size (D)	Smooth	€	D1	H	L	M	Pack
435200020G		1/4	●	5,08	-	35	46	43	12
435200030G		3/8	●	5,08	-	35	47	43	12
435200043G		1/2	●	5,94	-	42	61	54	12
435200053G		3/4	●	8,41	-	45	68	54	8
435200063G		1"	●	13,17	-	51	81	64	6

A norma UNI EN 331



Valvola a sfera PN30 MF per gas tipo export, passaggio totale, maniglia a leva

MF full bore gas ball valve PN30, export pattern with lever handle

Válvula de bola PN30 MH para gas tipo export, paso total, manija de palanca

424R

Code	Version	Size (D)	Smooth	€	D1	H	L	M	Pack
424R00043B	-	1/2	●	4,88	-	52	54	93	12
424R00053B	-	3/4	●	7,06	-	57	66	93	10
424R00063B	-	1"	●	9,90	-	62	77	112	6
424R00073B	-	1" 1/4	●	17,91	-	66	91	112	6
424R00083B	-	1" 1/2	●	25,81	-	77	101	143	4
424R00093B	-	2"	●	40,02	-	81	117	143	2

A norma UNI EN 331

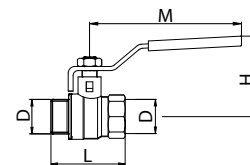

Valvola a sfera PN30 FF per gas tipo export, passaggio totale, maniglia a leva

FF full bore gas ball valve PN30, export pattern with lever handle

Válvula de bola PN30 HH para gas tipo export paso total, manija de palanca

425R

Code	Version	Size (D)	Smooth	€	D1	H	L	M	Pack
425R00043B	-	1/2	●	5,10	-	52	57	93	12
425R00053B	-	3/4	●	6,79	-	57	63	93	10
425R00063B	-	1"	●	9,84	-	62	75	112	6
425R00073B	-	1" 1/4	●	17,11	-	66	84	112	6
425R00083B	-	1" 1/2	●	24,89	-	77	92	143	4
425R00093B	-	2"	●	39,09	-	81	106	143	4

A norma UNI EN 331

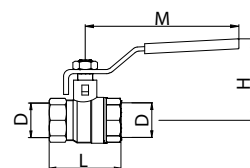

Valvola a sfera PN30 MF per gas tipo export, passaggio totale, maniglia a T

MF full bore gas ball valve PN30, export pattern with T-handle

Válvula de bola PN30 MH para gas tipo export, paso total, manija de mariposa

434R

Code	Version	Size (D)	Smooth	€	D1	H	L	M	Pack
434R00043G	-	1/2	●	4,88	-	42	54	54	20
434R00053G	-	3/4	●	7,06	-	45	66	54	15
434R00063G	-	1"	●	9,90	-	51	77	64	8

A norma UNI EN 331

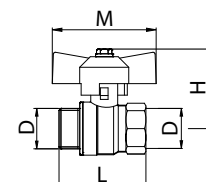

Valvola a sfera PN30 FF per gas tipo export, passaggio totale, maniglia a T

FF full bore gas ball valve PN30, export pattern with T-handle

Válvula de bola PN30 HH para gas tipo export paso total, manija de mariposa

435R

Code	Version	Size (D)	Smooth	€	D1	H	L	M	Pack
435R00043G	-	1/2	●	5,10	-	42	57	54	20
435R00053G	-	3/4	●	6,79	-	45	63	54	15
435R00063G	-	1"	●	9,84	-	51	75	64	8

A norma UNI EN 331

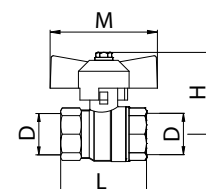



B GREEN

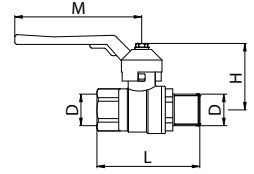

424/1



Valvola a sfera MF PN40 per acqua potabile anti legionella, maniglia a leva

MF brass ball valve PN40, for drinking water, antilegionnaire's disease, lever handle

Válvula esfera MH PN40 para agua potable antilegionella, manija de palanca



Code	Version	Size (D)	Smooth	€	D1	H	L	M	Pack
424100040C	-	1/2	●	6,56	-	52	57	93	12
424100050C	-	3/4	●	9,16	-	57	63	93	8
424100060C	-	1"	●	14,16	-	62	75	112	6
424100070C	-	1" 1/4	●	24,65	-	66	84	112	4
424100080C	-	1" 1/2	●	33,92	-	77	92	143	4
424100090C	-	2"	●	55,22	-	81	106	143	2

Conforme alla norma EN 13828

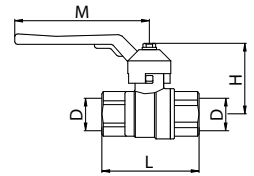

425/1



Valvola a sfera FF PN40 per acqua potabile anti legionella, maniglia a leva

FF brass ball valve PN40, for drinking water, antilegionnaire's disease, lever handle

Válvula esfera HH PN40 para agua potable antilegionella, manija de palanca



Code	Version	Size (D)	Smooth	€	D1	H	L	M	Pack
425100040C	-	1/2	●	6,18	-	52	54	93	12
425100050C	-	3/4	●	8,68	-	57	66	93	8
425100060C	-	1"	●	13,54	-	62	77	112	6
425100070C	-	1" 1/4	●	24,23	-	66	91	112	4
425100080C	-	1" 1/2	●	32,25	-	77	101	143	4
425100090C	-	2"	●	52,70	-	81	117	143	2

Conforme alla norma EN 13828

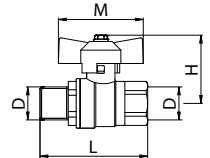

434/1



Valvola a sfera MF PN40 per acqua potabile anti legionella, maniglia a T

MF brass ball valve PN40, for drinking water, antilegionnaire's disease, T-handle

Válvula esfera MH PN40 para agua potable antilegionella, manija de mariposa



Code	Version	Size (D)	Smooth	€	D1	H	L	M	Pack
434100040H	-	1/2	●	6,56	-	42	57	54	12
434100050H	-	3/4	●	9,16	-	45	63	54	8
434100060H	-	1"	●	14,16	-	51	75	64	6

Conforme alla norma EN 13828

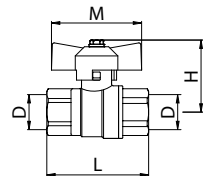

435/1



Valvola a sfera FF PN40 per acqua potabile anti legionella, maniglia a T

FF brass ball valve PN40, for drinking wather, antilegionnaire's disease, T-handle

Válvula esfera HH PN40 para agua potable antilegionella, manija de mariposa



Code	Version	Size (D)	Smooth	€	D1	H	L	M	Pack
435100040H	-	1/2	●	6,18	-	42	54	54	12
435100050H	-	3/4	●	8,68	-	45	66	54	8
435100060H	-	1"	●	13,54	-	51	77	64	6

Conforme alla norma EN 13828



Finitura: ● Giallo/Yellow
Smooth: ● Cromo/Chrome
● Nichel/Nikel

L'ultima lettera del codice indica il tipo e il colore della maniglia

E Alluminio BLU
F Alluminio ROSSA
G Alluminio GIALLA
H Alluminio VERDE
M Alluminio NERA
A Ferro ROSSA
B Ferro GIALLA
C Ferro VERDE
D Ferro BLU
N Ferro NERA



Valvola a sfera FF passaggio totale PN25 in **ADZ**

Female-female full bore ADZ brass ball valve PN25, lever handle

Válvula de bola HH con paso total PN25, de ADZ

425BZ ADZ brass

Code	Version	Size (D)	Smooth	€	D1	H	L	M	Pack
425B0003ZA		3/8"	●	5,38	-	38	47,5	81	12
425B0004ZA		1/2"	●	5,38	-	52	50	93	12
425B0005ZA		3/4"	●	7,39	-	57	57	93	10
425B0006ZA		1"	●	11,26	-	62	68	112	6
425B0007ZA		1" 1/4	●	20,58	-	66	84	112	6
425B0008ZA		1" 1/2	●	29,63	-	77	93,5	143	4
425B0009ZA		2"	●	45,07	-	81	108	143	4

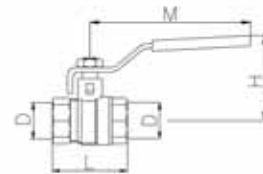

Valvola a sfera tuborame, in **ADZ** a compressione

Full bore ADZ brass ball valve with copper to copper compression, lever handle

Válvula de bola empalmes tubo de cobre, de compresion, de ADZ

438 ADZ brass

Code	Version	Size (D)	Smooth	€	D1	H	L	M	Pack
43800003AA		12	●	7,99	-	40	69	84	10
43800004AA		15	●	7,99	-	40	70	84	10
43800004AA		18	●	8,22	-	40	72	84	10
43800005AA		22	●	10,33	-	55	74	92,5	5
43800006AA		28	●	18,39	-	61	84	112	4

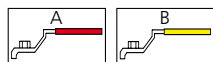
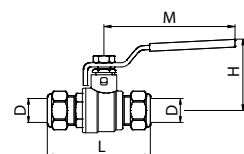

Valvola a sfera passaggio totale con raccordi a pressare in ottone **ADZ**

Full port brass ball valve with press-fit ends - ADZ brass

Válvula de bola, paso total con racores de prensar de ADZ

537E ADZ brass

Code	Version	Size (D)	Smooth	€	D1	H	L	M	Pack
537E00030A	-	3/8	●	7,50	12	52	78	93	10
537E00040_	A/B	1/2	●	7,50	15	52	78	93	10
537E00050_	A/B	3/4	●	10,99	22	56	92	93	8
537E00060_	A/B	1"	●	15,71	28	67	98	112	5
537E00070_	A/B	1" 1/4	●	20,92	35	70	109	112	4
537E00080_	A/B	1" 1/2	●	30,84	42	78	132	143	4
537E00090_	A/B	2"	●	48,62	54	86	163	143	2

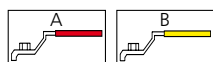
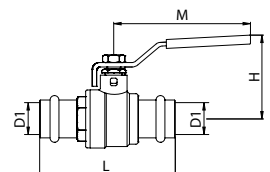

Valvola a sfera passaggio totale F con raccordo a pressare in ottone **ADZ**

F full port brass ball valve with press-fit ends - ADZ brass

Válvula de bola, paso total F con racores de prensar de ADZ

560E ADZ brass

Code	Version	Size (D)	Smooth	€	D1	H	L	M	Pack
560E00030A	-	3/8	●	7,73	12	52	61	93	10
560E00040_	A/B	1/2	●	7,73	15	52	66	93	10
560E00050_	A/B	3/4	●	10,09	22	56	76,5	93	8
560E00060_	A/B	1"	●	14,52	28	67	86	112	5
560E00070_	A/B	1" 1/4	●	19,63	35	70	92	112	4
560E00080_	A/B	1" 1/2	●	27,70	42	78	110	143	4
560E00090_	A/B	2"	●	44,22	54	86	132,5	143	2

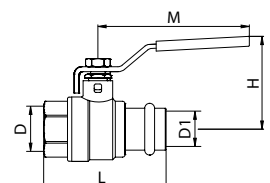



Valvola a sfera FF incasso,
con maniglia a leva
*Built-in female-female ball
valve with chromed lever
handle*
*Válvula de bola HH para
encastrar con manija de
palanca*



Valvola a sfera FF incasso con
cappuccio
*Built-in female-female ball
valve with chromed cap*
*Válvula de bola HH para
encastrar con capuchón
cromado*



Valvola a sfera FF incasso
con maniglia
*Built-in female-female ball
valve with chromed handle*
*Válvula de bola HH para
encastrar con manija
cromada*

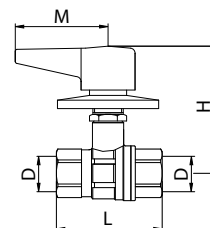

428

Code	Version	Size (D)	Smooth	€	D1	H	L	M	Pack
4280000400		1/2	●	11,79	-	78	59	54	8
4280000500		3/4	●	14,60	-	85	69	54	5
4280000600		1"	●	30,52	-	90	82	54	5

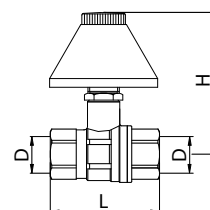

429

Code	Version	Size (D)	Smooth	€	D1	H	L	M	Pack
4290000400		1/2	●	11,53	-	75/90	59	-	10
4290000500		3/4	●	14,12	-	77/92	69	-	5
4290000600		1"	●	29,63	-	80/95	82	-	5

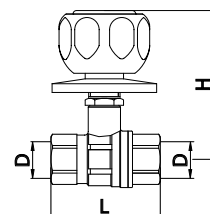

430

Code	Version	Size (D)	Smooth	€	D1	H	L	M	Pack
4300000400		1/2	●	12,72	-	79	59	-	8
4300000500		3/4	●	15,42	-	85	69	-	6



Valvola a sfera FF
"MINI"
"MINI" female-female
ball valve
Válvula de bola HH
"MINI"

426

Code	Version	Size (D)	Smooth	€	D1	H	h	l	L	Pack
4260000100		1/8	●	3,68	-	-	-	-	39	30
4260000200		1/4	●	3,68	-	-	-	-	39	30
4260000300		3/8	●	3,68	-	-	-	-	42	30
4260000400		1/2	●	4,26	-	-	-	-	47	25
4260000500		3/4	●	7,39	-	-	-	-	54	15

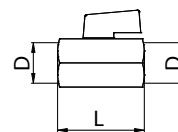

Valvola a sfera MF
"MINI"
"MINI" male-female
ball valve
Válvula de bola MH
"MINI"

427

Code	Version	Size (D)	Smooth	€	D1	H	h	l	L	Pack
4270000100		1/8	●	3,55	-	-	-	-	39	30
4270000200		1/4	●	3,55	-	-	-	-	39	30
4270000300		3/8	●	3,42	-	-	-	-	42	30
4270042500		1/2	●	4,17	-	-	-	-	47	25
4270000500		3/4	●	7,39	-	-	-	-	54	15

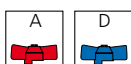
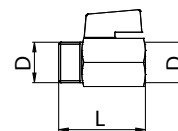

Valvola a sfera
stampata MINI MF,
leva in alluminio
MINI male female
forged brass ball valve
lever aluminium handle
Válvula de bola
moldeada MH MINI,
manija aluminio

427G

Code	Version	Size (D)	Smooth	€	D1	H	h	l	L	Pack
427G00040_	A/D	1/2"	●	3,87	1/2"	21,5	-	-	47	25
427GN0040_	A/D	1/2"	●	4,03	1/2"	21,5	-	-	47	25

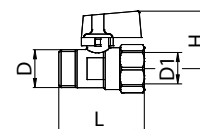

Valvola a sfera MINI
MM a compressione,
maniglia nera
MM Mini ball valve
compression ends,
black lever
Válvula de bola mini
MM a' compresión,
palanca negra

427DD

Code	Version	Size (D)	Smooth	€	D1	H	h	l	L	Pack
427DD10100		10x10	●	5,80	-	-	-	-	65	20
427DD12120		12x12	●	5,80	-	-	-	-	65	20
427DD15150		15x15	●	6,62	-	-	-	-	65	20

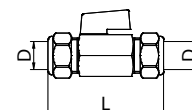



Valvola a sfera MINI MM con taglio cacciavite e 2 dadi
Male male Mini ball valve, screwdriver slot and 2 nuts
Valvula de bola mini MM con con destornillador y dos dados

427MC

Code	Version	Size (D)	Smooth	€	D1	H	I	L	Pack
427MC01500		15	●	6,05	-	-	-	65	20
427MC01510		15x10	●	5,84	-	-	-	65	20
427MC01512		15x12	●	5,84	-	-	-	65	20

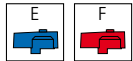
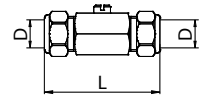

Valvola a sfera con attacco maschio per tubo di plastica, leva in alluminio
Ball valve male connection for plastic tube, lever aluminium handle
Válvula de bola empalme M para tubo de plástico, manija aluminio

828

Code	Version	Size (D)	Smooth	€	D1	H	I	L	Pack
828000252_	E/F	1/2"	●	5,84	15X2,5	33	-	59	25
828000253_	E/F	1/2"	●	5,84	16X2	33	-	59	25
828000259_	E/F	1/2"	●	6,11	18X2	33	-	59	25
82800025N_	E/F	1/2"	●	6,11	18X2,5	33	-	59	25

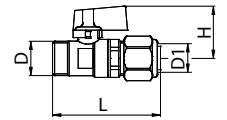

829

Code	Version	Size (D)	Smooth	€	D1	H	I	L	Pack
829000253_	E/F	1/2"	●	6,33	16X2	33	-	61	25

Per tubo multistrato - For multilayer tube - Para tubo multicapa

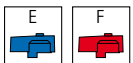

Valvola a sfera tuborame con dado e ogiva, leva in alluminio
Full bore ball valve with copper to copper compression, with nut and tailpiece, lever aluminium handle
Válvula del bola para tubo de cobre con tuerca y ovalillo, manija aluminio

438G

Code	Version	Size (D)	Smooth	€	D1	H	I	L	Pack
438G04250_	E/F	1/2"	●	6,14	15	21,5	-	59	25
438G04260_	E/F	1/2"	●	6,14	16	21,5	-	59	25

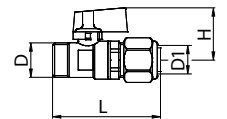



Valvola a sfera a tre vie,
manovra a L.
Per fluidi non pericolosi
(gruppo 2)
*3 outlets ball valve, L-handle.
For not dangerous fluids
(group 2)*
*Válvula de bola de 3 vías,
maniobra en L
Para fluidos no peligrosos
(grupo 2)*

Valvola a sfera a tre vie,
manovra a T.
Per fluidi non pericolosi
(gruppo 2)
*3 outlets ball valve, T-handle.
For not dangerous fluids
(group 2)*
*Válvula de bola de 3 vías,
maniobra en T
Para fluidos no peligrosos
(grupo 2)*



Valvola a sfera flangiata in
ghisa
Flanged ball valve
*Válvula de bola rebordeada
de fundición*

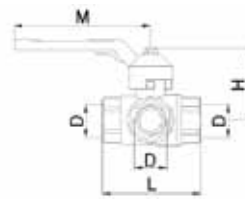

4253L

Code	Version	Size (D)	Smooth	€	Bar	H	L	M	Pack
4253L0030F		3/8	●	28,65	40	65	77	125	4
4253L0040F		1/2	●	28,65	40	65	77	125	4
4253L0050F		3/4	●	43,92	40	83	92	145	2
4253L0060F		1"	●	65,53	40	96	104	170	2
4253L0070F		1" 1/4	●	98,44	35	102	118	170	2
4253L0080F		1" 1/2	●	140,60	25	109	138	170	2
4253L0090F		2"	●	211,38	20	139	162	260	2

4253T

Code	Version	Size (D)	Smooth	€	Bar	H	L	M	Pack
4253T0030F		3/8	●	28,65	40	65	77	125	4
4253T0040F		1/2	●	28,65	40	65	77	125	4
4253T0050F		3/4	●	43,92	40	83	92	145	2
4253T0060F		1"	●	65,53	40	96	104	170	2
4253T0070F		1" 1/4	●	98,44	35	102	118	170	2
4253T0080F		1" 1/2	●	140,60	25	109	138	170	2
4253T0090F		2"	●	211,38	20	139	162	260	2

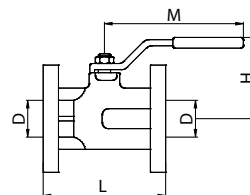

4254

Code	Version	Size (D)	Smooth	€	D1	H	L	M	Pack
425400050D		20	●	102,55	20	85	120	130	-
425400060D		25	●	120,88	25	95	125	170	-
425400070D		32	●	133,70	32	100	130	170	-
425400080D		40	●	153,86	40	118	140	220	-
425400090D		50	●	172,16	50	125	150	220	-
425400100D		65	●	210,61	65	152	170	284	-
425400110D		80	●	274,74	80	166	180	284	-
425400120D		100	●	364,46	100	180	190	360	-



Raccordo a 3 vie in **ADZ**
3 ways coupling, **ADZ** brass
Empalme 3 vías, de **ADZ**

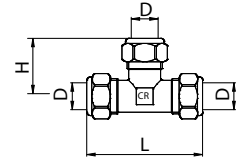

710 ADZ brass

Code	Version	Size (D)	Smooth	€	D1	H	L	M	Pack
710004200A		10	●	4,60	-	32	65	-	25
710004220A		12	●	4,60	-	32	65	-	25
710004250A		15	●	5,54	-	34	69	-	25
710004280A		18	●	7,06	-	36	70	-	25
710004320A		22	●	8,81	-	36	70	-	10
710004380A		28	●	12,73	-	47	94	-	10
71000121012		12x10x12	●	4,42	-	32	65	-	25
71000151215		15x12x15	●	4,90	-	34	69	-	25
71000181518		18x15x18	●	6,66	-	36	70	-	25
71000221522		22x15x22	●	10,10	-	36	70	-	10
7100C4200A		10	●	4,87	-	32	65	-	25
7100C4220A		12	●	4,87	-	32	65	-	25
7100C4250A		15	●	5,99	-	34	69	-	25
7100C4280A		18	●	7,06	-	36	70	-	25
7100C4320A		22	●	8,81	-	36	70	-	10
7100C121012		12x10x12	●	4,91	-	32	65	-	25
7100C151215		15x12x15	●	5,43	-	34	69	-	25



Raccordo diritto doppio in **ADZ**
Straight double coupling **ADZ** brass
Empalme recto doble de **ADZ**

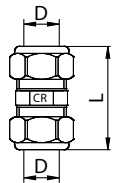

712 ADZ brass

Code	Version	Size (D)	Smooth	€	D1	H	L	M	Pack
712004200A		10	●	2,52	-	-	40	-	50
712004220A		12	●	2,52	-	-	40	-	50
712004250A		15	●	3,05	-	-	42	-	25
712004280A		18	●	4,01	-	-	49	-	25
712004320A		22	●	4,90	-	-	49	-	25
712004380A		28	●	8,12	-	-	55	-	25
7120001210		12x10	●	2,43	-	-	40	-	50
7120001510		15x10	●	2,98	-	-	42	-	50
7120001512		15x12	●	2,98	-	-	42	-	50
7120001815		18x15	●	4,54	-	-	47	-	25
7120002215		22x15	●	4,15	-	-	47	-	25
7120002218		22x18	●	4,82	-	-	49	-	25
7120C4200A		10	●	2,78	-	-	40	-	50
7120C4220A		12	●	2,78	-	-	40	-	50
7120C4250A		15	●	3,36	-	-	42	-	25
7120C4280A		18	●	4,30	-	-	49	-	25
7120C4320A		22	●	5,36	-	-	49	-	25
7120C01210		12x10	●	2,59	-	-	40	-	50
7120C01510		15x10	●	3,20	-	-	42	-	50
7120C01512		15x12	●	3,20	-	-	42	-	50

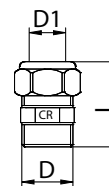

Raccordo semplice con attacco maschio in **ADZ**
*Straight male coupling **ADZ** brass*
*Racor simple con empalme macho de **ADZ***



714 ADZ brass

Code	Version	Size (D)	Smooth	€	D1	H	L	M	Pack
714003200A		3/8x10	●	1,94	-	-	29	-	50
714003220A		3/8x12	●	1,94	-	-	29	-	50
714003250A		3/8x15	●	2,17	-	-	31	-	50
714004200A		1/2x10	●	2,29	-	-	31	-	50
714004220A		1/2x12	●	2,29	-	-	31	-	50
714004250A		1/2x15	●	2,38	-	-	33	-	50
714004280A		1/2x18	●	2,97	-	-	39	-	25
714004320A		1/2x22	●	4,13	-	-	39	-	25
714005250A		3/4x15	●	3,06	-	-	34	-	25
714005280A		3/4x18	●	3,39	-	-	40	-	25
714005320A		3/4x22	●	3,64	-	-	40	-	25
714006320A		1"x22	●	4,49	-	-	45	-	25
714006380A		1"x28	●	5,82	-	-	45	-	25
7140C3200A		3/8x10	●	2,10	-	-	29	-	50
7140C3220A		3/8x12	●	2,10	-	-	29	-	50
7140C3250A		3/8x15	●	2,37	-	-	31	-	50
7140C4200A		1/2x10	●	2,50	-	-	31	-	50
7140C4220A		1/2x12	●	2,50	-	-	31	-	50
7140C4250A		1/2x15	●	2,60	-	-	33	-	50
7140C4280A		1/2x18	●	3,39	-	-	39	-	25
7140C5250A		3/4x15	●	3,41	-	-	34	-	25
7140C5320A		3/4x22	●	4,03	-	-	40	-	25

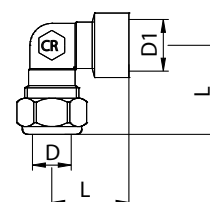

Raccordo curvo femmina con dado, in **ADZ**
*Angle coupling with nut, female connection, **ADZ** brass*
*Codo de union hembra con tuerca, de **ADZ***



716 ADZ brass

Code	Version	Size (D)	Smooth	€	D1	H	L	M	Pack
716003200A		3/8x10	●	3,40	-	31	30	-	25
716003220A		3/8x12	●	3,40	-	31	30	-	25
716003250A		3/8x15	●	3,73	-	31	30	-	25
716004200A		1/2x10	●	3,73	-	31	30	-	25
716004220A		1/2x12	●	3,73	-	31	30	-	25
716004250A		1/2x15	●	3,84	-	33	30	-	25
716004280A		1/2x18	●	4,54	-	40	31	-	25
716005280A		3/4x18	●	5,05	-	40	32	-	25
716005320A		3/4x22	●	5,29	-	40	32	-	25
716006380A		1"x28	●	7,55	-	47	39	-	10
7160C3220A		3/8x12	●	3,81	-	31	30	-	25
7160C3250A		3/8x15	●	4,12	-	31	30	-	25
7160C4200A		1/2x10	●	4,12	-	31	30	-	25
7160C4220A		1/2x12	●	4,12	-	31	30	-	25
7160C4250A		1/2x15	●	4,15	-	33	30	-	25



Raccordo curvo maschio con dado, in **ADZ**

Angle coupling with nut, male connection, **ADZ** brass

Codo de union macho con tuerca, de **ADZ**

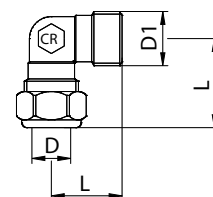

718 ADZ brass

Code	Version	Size (D)	Smooth	€	D1	H	L	M	Pack
718003200A		3/8x10	●	3,02	-	32	24	-	50
718003220A		3/8x12	●	3,02	-	32	24	-	50
718004200A		1/2x10	●	3,50	-	34	25	-	25
718004220A		1/2x12	●	3,50	-	34	25	-	25
718004250A		1/2x15	●	3,58	-	34	25	-	25
718004280A		1/2x18	●	4,90	-	39	25	-	25
718005250A		3/4x15	●	4,03	-	32	29	-	25
718005280A		3/4x18	●	5,44	-	40	31	-	25
718005320A		3/4x22	●	5,35	-	40	31	-	25
718006380A		1" x28	●	7,49	-	46	38	-	10
7180C3220A		3/8x12	●	3,07	-	32	24	-	50
7180C4200A		1/2x10	●	3,70	-	34	25	-	25
7180C4220A		1/2x12	●	3,70	-	34	25	-	25
7180C4250A		1/2x15	●	3,81	-	34	25	-	25
7180C4280A		1/2x18	●	5,09	-	39	25	-	25
7180C5250A		3/4x15	●	4,15	-	32	29	-	25

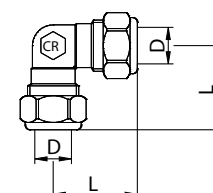

722 ADZ brass

Code	Version	Size (D)	Smooth	€	D1	H	L	M	Pack
722004200A		Ø10	●	3,39	-	-	32	-	25
722004220A		Ø12	●	3,39	-	-	32	-	25
722004250A		Ø15	●	4,29	-	-	34	-	25
722004280A		Ø18	●	5,56	-	-	39	-	25
722004320A		Ø22	●	6,35	-	-	40	-	25
722004380A		Ø28	●	9,71	-	-	47	-	10
7220C4200A		Ø10	●	3,69	-	-	32	-	25
7220C4220A		Ø12	●	3,69	-	-	32	-	25
7220C4250A		Ø15	●	4,59	-	-	34	-	25
7220C4280A		Ø18	●	5,74	-	-	39	-	25
7220C4320A		Ø22	●	6,46	-	-	40	-	25



Raccordo curvo doppio in **ADZ**

Double elbow coupling **ADZ** brass

Codo de union doble de **ADZ**





Raccordo curvo in **ADZ** con staffaggio

ADZ backplate angle coupling

Codo de union a esquadra de **ADZ** con soporte

723 ADZ brass

Code	Version	Size (D)	Smooth	€	D1	H	L	M	Pack
7230C4220A		1/2X12	●	4,68	-	26	28	42	25
7230C4250A		1/2x15	●	4,68	-	26	28	42	25

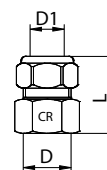

Raccordo semplice con attacco femmina in **ADZ**

Straight female coupling ADZ brass

Racor simple con empalme hembra de ADZ

730 ADZ brass

Code	Version	Size (D)	Smooth	€	D1	H	L	M	Pack
730003220A		3/8x12	●	2,23	-	-	30	-	50
730003250A		3/8x15	●	2,54	-	-	30	-	50
730004200A		1/2x10	●	2,37	-	-	30	-	50
730004220A		1/2x12	●	2,37	-	-	30	-	50
730004250A		1/2x15	●	2,33	-	-	32	-	50
730004280A		1/2x18	●	3,33	-	-	35	-	25
730004320A		1/2x22	●	3,91	-	-	35	-	25
730005250A		3/4x15	●	3,50	-	-	35	-	25
730005280A		3/4x18	●	3,56	-	-	36	-	25
730005320A		3/4x22	●	3,76	-	-	36	-	25
730006320A		1"x22	●	5,48	-	-	40	-	25
730006380A		1"x28	●	5,93	-	-	40	-	25
7300C3200A		3/8x10	●	2,53	-	-	30	-	50
7300C3220A		3/8x12	●	2,53	-	-	30	-	50
7300C3250A		3/8x15	●	2,76	-	-	30	-	50
7300C4200A		1/2x10	●	2,53	-	-	30	-	50
7300C4220A		1/2x12	●	2,53	-	-	30	-	50
7300C4250A		1/2x15	●	2,57	-	-	32	-	50





Ogiva in **ADZ**
ADZ olive for 10mm pipe
Ojiva de ADZ para tubo 10mm

735 ADZ brass

Code	Version	Size (D)	Smooth	€	D1	H	L	M	Pack
7350000100		10	●	0,18	-	-	-	-	-
7350000120		12	●	0,21	-	-	-	-	-
7350000150		15	●	0,23	-	-	-	-	-
7350000180		18	●	0,28	-	-	-	-	-
7350000220		22	●	0,31	-	-	-	-	-
7350000280		28	●	0,58	-	-	-	-	-



Bussola di rinforzo per
tubo rame
Collar for copper tube
Brújula de refuerzo para tubo de cobre

738

Code	Version	Size (D)	Smooth	€	D1	H	L	M	Pack
7380000100		10	●	0,41	-	-	-	-	-
7380000120		12	●	0,44	-	-	-	-	-
7380000150		15	●	0,56	-	-	-	-	-
7380000220		22	●	1,05	-	-	-	-	-



Ogiva riduzione in **ADZ**
ADZ Reduction Olive
Ojiva de reducción de ADZ

739 ADZ brass

Code	Version	Size (D)	Smooth	€	D1	H	L	M	Pack
739001008A		10x8	●	0,73	-	-	-	-	100
739001208A		12x8	●	0,73	-	-	-	-	100
739001210A		12x10	●	0,73	-	-	-	-	100
739001510A		15x10	●	1,09	-	-	-	-	100
739001512A		15x12	●	0,84	-	-	-	-	100
739001812A		18x12	●	1,17	-	-	-	-	50
739001815A		18x15	●	1,12	-	-	-	-	50
739002215A		22x15	●	1,33	-	-	-	-	50
739002218A		22x18	●	1,70	-	-	-	-	50
739002822A		28x22	●	1,99	-	-	-	-	50

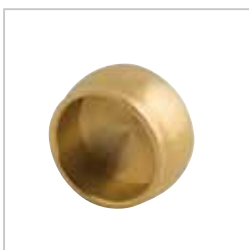

Ogiva a tappo in **ADZ**
ADZ brass cap olive
Ojiva de lanceta de ADZ

740 ADZ brass

Code	Version	Size (D)	Smooth	€	D1	H	L	M	Pack
740000010A		10	●	1,06	-	-	-	-	100
740000012A		12	●	1,06	-	-	-	-	100
740000015A		15	●	1,24	-	-	-	-	100
740000018A		18	●	1,88	-	-	-	-	100
740000022A		22	●	2,11	-	-	-	-	100



Raccordo maschio a T
Tee male
Racor macho T



810

Code	Version	Size (D)	Smooth	€	D1	H	L	M	Pack
8100N00400		1/2x16x1/2x16x1/2x16	●	3,09	-	-	-	-	-



Raccordo diritto maschio
Straight male coupling
Empalme recto macho



812

Code	Version	Size (D)	Smooth	€	D1	H	L	M	Pack
8120N00400		1/2x16x1/2x16	●	1,45	-	-	-	-	-



Raccordo semplice con
attacco maschio
Straight male coupling
Racor simple macho



814

Code	Version	Size (D)	Smooth	€	D1	H	L	M	Pack
8140N32600		3/8x1/2x16	●	1,52	-	-	-	-	-
8140N42600		1/2x1/2x16	●	1,46	-	-	-	-	-
8140N52600		3/4x1/2x16	●	1,88	-	-	-	-	-



Raccordo curvo femmina
*Angle coupling female
connection*
Codo de union hembra



816

Code	Version	Size (D)	Smooth	€	D1	H	L	M	Pack
8160N42600		1/2x1/2x16	●	2,78	-	-	-	-	-



Raccordo curvo maschio
*Angle coupling male
connection*
Codo de union macho



818

Code	Version	Size (D)	Smooth	€	D1	H	L	M	Pack
8180N42600		1/2x1/2x16	●	2,53	-	-	-	-	-



Raccordo curvo doppio
Double elbow coupling
Codo de union doble

822

Code	Version	Size (D)	Smooth	€	D1	H	L	M	Pack
8220N00400		1/2x16x1/2x16	●	2,53	-	-	-	-	-



Raccordo curvo con staffa
Backplate angle coupling
Codo de union a esquadra con soporte

823

Code	Version	Size (D)	Smooth	€	D1	H	L	M	Pack
8230N00400		1/2Fx1/2x16	●	3,32	-	-	-	-	-



Raccordo semplice con attacco femmina
Straight female coupling
Racor simple con empalma hembra

830

Code	Version	Size (D)	Smooth	€	D1	H	L	M	Pack
8300N32600		3/8x1/2x16	●	1,58	-	-	-	-	-
8300N00400		1/2x1/2x16	●	1,29	-	-	-	-	-
8300N52600		3/4x1/2x16	●	2,02	-	-	-	-	-



422-424-424/2-425-425/2-428-429-434-434/2-435-435/2-436-437

Size	1/4"	3/8"	1/2"	3/4"	1"	1 1/4"	1 1/2"	2"	2 1/2"	3"	4"
DN mm	10	10	15	20	25	32	40	50	65	80	100
PN bar	40	40	40	40	40	40	40	40	16	16	16
KV m ³ /h	6,2	6,2	16	29,5	43	90	225	250	400	540	900

PASSAGGIO TOTALE

424A-425A-434A-435A-422B-424B-425B-434B-435B-422R-424R-425R-434R-435R-438

Size	1/2"	3/4"	1"	1 1/4"	1 1/2"	2"	2 1/2"	3"
DN mm	14	19	23,5	30	37	46	65	80
PN bar	30	30	30	25	25	25	16	16
KV m ³ /h	15	28	41	86	215	235	400	540

PASSAGGIO TOTALE

426-427

Size	1/4"	3/8"	1/2"	3/4"
DN mm	8	8	10	12
PN bar	16	16	16	16
KV m ³ /h	2,8	2,8	5,6	10,3

Diagramma pressione-temperatura

Pn= bar T= °C



Diagramma perdite di carico

Δp = mm H₂O G= l/h



Δp = Perdita di carico in mm H₂O
G= Portata in l/h

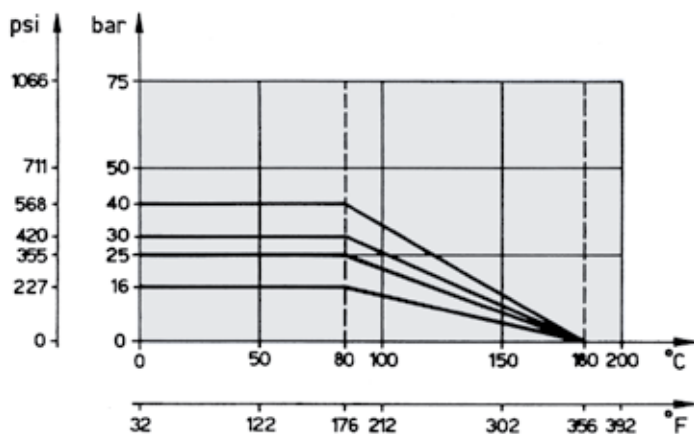
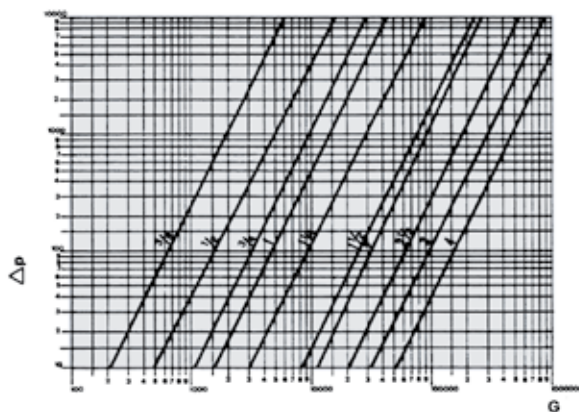

BIANCHI F.lli S.p.a.
Rubinetteria

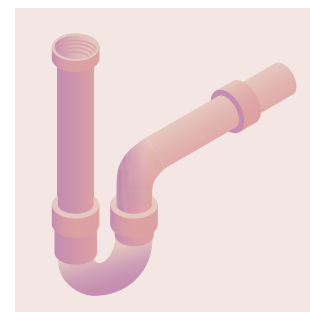
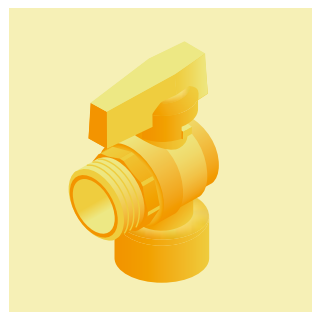
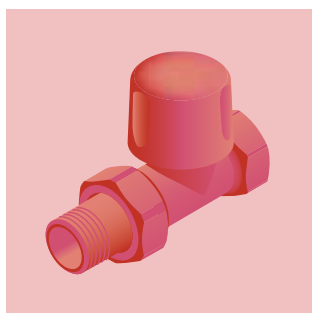
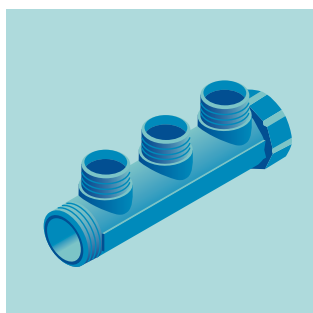

MADE IN ITALY
www.bianchifratelli.it