

# RUBINETTERIA IDRAULICA

## *Valves for water*

### **CARATTERISTICHE TECNICO/COSTRUTTIVE GENERALI**

- **Materiali**
  - Corpo e accessori: ottone UNI EN 12165-CW617N stampato a caldo e ottone UNI EN 12164-CW614N tornito
  - Guarnizioni: NBR e PTFE puro
- Tipi di filettature: ISO 228
- Durante le lavorazioni tutti i particolari sono controllati secondo modalità definite nelle procedure del sistema qualità aziendale, certificato secondo la norma UNI EN ISO 9001:2008

Le caratteristiche e le misure sono indicative e non impegnano la BIANCHI F.LLI, che si riserva il diritto di apportare ai propri articoli, in qualunque momento e senza preavviso, modifiche tecniche o commerciali.



**BIANCHI F.lli S.p.a.**  
Rubinetteria

---

MADE IN ITALY  
[www.bianchifratelli.it](http://www.bianchifratelli.it)

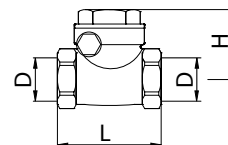
 Valvola clapet  
 Swing check brass valve  
 Válvula clapet

**439**

Code	Version	Size (D)	Smooth	€	D1	H	L	M	Pack
4390000300		3/8	●	<b>7,23</b>	-	50	43	-	16
4390000400		1/2	●	<b>6,64</b>	-	50	44	-	16
4390000500		3/4	●	<b>9,25</b>	-	58	53	-	12
4390000600		1"	●	<b>14,07</b>	-	67	63	-	8
4390000700		1" 1/4	●	<b>20,51</b>	-	77	72	-	5
4390000800		1" 1/2	●	<b>26,46</b>	-	88	82	-	4
4390000900		2"	●	<b>37,28</b>	-	101	95	-	2
4390001000		2" 1/2	●	<b>75,65</b>	-	130	119	-	1
4390001100		3"	●	<b>105,16</b>	-	150	133	-	1
4390001200		4"	●	<b>195,29</b>	-	185	168	-	1

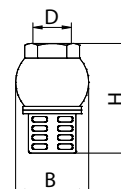
 Valvola di fondo  
 Brass foot valve  
 Válvula de fondo

**441**

Code	Version	Size (D)	Smooth	€	D1	H	L	M	Pack
4410000400		1/2	●	<b>7,03</b>	-	60	39	-	20
4410000500		3/4	●	<b>8,03</b>	-	69	45	-	12
4410000600		1"	●	<b>9,67</b>	-	80	51	-	12
4410000700		1" 1/4	●	<b>13,99</b>	-	92	61	-	5
4410000800		1" 1/2	●	<b>18,44</b>	-	100	68	-	3
4410000900		2"	●	<b>26,70</b>	-	117	80	-	2
4410001000		2" 1/2	●	<b>47,99</b>	-	140	100	-	1
4410001100		3"	●	<b>64,43</b>	-	173	121	-	1
4410001200		4"	●	<b>109,50</b>	-	194	145	-	1

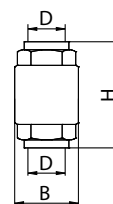
 Valvola di ritegno  
 Brass check valve  
 Válvula de retención

**442**

Code	Version	Size (D)	Smooth	€	D1	H	L	M	Pack
4420000300		3/8	●	<b>6,90</b>	-	55	34	-	10
4420000400		1/2	●	<b>6,94</b>	-	58	34	-	10
4420000500		3/4	●	<b>9,44</b>	-	65	42	-	8
4420000600		1"	●	<b>12,81</b>	-	74	48	-	6
4420000700		1" 1/4	●	<b>20,37</b>	-	83	60	-	4
4420000800		1" 1/2	●	<b>27,53</b>	-	93	71	-	4
4420000900		2"	●	<b>42,23</b>	-	101	87	-	2
4420001000		2" 1/2	●	<b>97,45</b>	-	122	120	-	1
4420001100		3"	●	<b>147,05</b>	-	141	140	-	1
4420001200		4"	●	<b>244,48</b>	-	158	172	-	1



Filtro per valvola di ritegno  
Filter for brass check valve  
Filtro para válvula de retención

**444**

Code	Version	Size (D)	Smooth	€	D1	H	L	M	Pack
4440000300		3/8	●	<b>1,08</b>	-	42	25	-	30
4440000400		1/2	●	<b>1,10</b>	-	47	29	-	50
4440000500		3/4	●	<b>1,25</b>	-	57	36	-	20
4440000600		1"	●	<b>1,45</b>	-	69	43	-	20
4440000700		1" 1/4	●	<b>1,88</b>	-	75	50	-	12
4440000800		1" 1/2	●	<b>2,35</b>	-	83	56	-	12
4440000900		2"	●	<b>3,15</b>	-	98	69	-	6
4440001000		2" 1/2	●	<b>5,96</b>	-	123	86	-	1
4440001100		3"	●	<b>7,21</b>	-	138	102	-	1
4440001200		4"	●	<b>9,81</b>	-	152	129	-	1

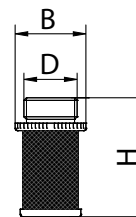

Valvola di ritegno tipo york  
Brass check valve, york type  
Válvula de retención tipo york

**442Y**

Code	Version	Size (D)	Smooth	€	D1	H	L	M	Pack
442Y000400		1/2	●	<b>5,05</b>	-	47	34	-	10
442Y000500		3/4	●	<b>6,98</b>	-	53	42	-	8
442Y000600		1"	●	<b>8,94</b>	-	60	47	-	8
442Y000700		1" 1/4	●	<b>13,28</b>	-	66	59	-	6
442Y000800		1" 1/2	●	<b>19,57</b>	-	74	71	-	4
442Y000900		2"	●	<b>27,23</b>	-	80	86	-	2
442Y001000		2" 1/2	●	<b>50,51</b>	-	98	102	-	1
442Y001100		3"	●	<b>71,66</b>	-	103	125	-	1
442Y001200		4"	●	<b>125,89</b>	-	118	154	-	1

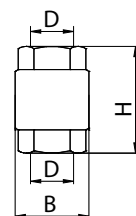

Saracinesca in ottone pesante  
PN20  
Heavy pattern brass gate valve  
PN20  
Cierre de latón pesado PN20

**445**

Code	Version	Size (D)	Smooth	€	D1	H	L	M	Pack
4450000300		3/8	●	<b>6,07</b>	-	67	33	-	20
4450000400		1/2	●	<b>6,85</b>	-	68	43	-	20
4450000500		3/4	●	<b>9,52</b>	-	78	47	-	20
4450000600		1"	●	<b>13,30</b>	-	93	53	-	10
4450000700		1" 1/4	●	<b>19,12</b>	-	108	57	-	10
4450000800		1" 1/2	●	<b>25,12</b>	-	125	61	-	5
4450000900		2"	●	<b>36,70</b>	-	143	67	-	5
4450001000		2" 1/2	●	<b>59,60</b>	-	175	74	-	1
4450001100		3"	●	<b>79,04</b>	-	200	86	-	1
4450001200		4"	●	<b>140,67</b>	-	235	98	-	1

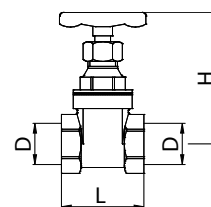



**BIANCHI F.lli S.p.a.**  
Rubinetteria

Finitura: ● Giallo/Yellow  
Smooth: ● Cromo/Chrome  
● Nichel/Nickel



Saracinesca in ottone leggero  
PN10

Light pattern brass gate valve  
PN10

Cierre de latón ligero PN10

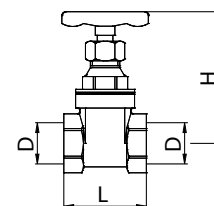

#### 446

Code	Version	Size (D)	Smooth	€	D1	H	L	M	Pack
4460000300		3/8	●	<b>6,07</b>	-	67	33	-	20
4460000400		1/2	●	<b>5,40</b>	-	68	35	-	20
4460000500		3/4	●	<b>5,97</b>	-	68	39	-	20
4460000600		1"	●	<b>8,59</b>	-	80	43	-	20
4460000700		1" 1/4	●	<b>13,32</b>	-	86	48	-	10
4460000800		1" 1/2	●	<b>16,94</b>	-	107	54	-	5
4460000900		2"	●	<b>25,83</b>	-	134	58	-	5
4460001000		2" 1/2	●	<b>52,31</b>	-	175	64	-	1
4460001100		3"	●	<b>67,97</b>	-	200	74	-	1
4460001200		4"	●	<b>117,55</b>	-	235	84	-	1



Rubinetto arresto pesante

Heavy pattern stop cock

Llave de cierre pesada

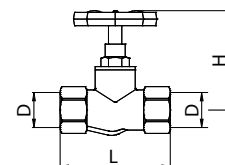

#### 450

Code	Version	Size (D)	Smooth	€	D1	H	L	M	Pack
4500000400		1/2	●	<b>8,90</b>	-	68	66	-	1
4500000500		3/4	●	<b>12,56</b>	-	76	74	-	1
4500000600		1"	●	<b>19,56</b>	-	98	99	-	1



Valvola di sicurezza per  
scaldabagno

Safety valve for boiler

Válvula de seguridad  
calentador

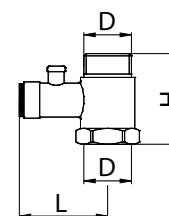

#### 453

Code	Version	Size (D)	Smooth	€	D1	H	L	M	Pack
4530000400		1/2	●	<b>3,97</b>	-	40	39	-	20



Rubinetto incasso con cappuccio  
*Heavy pattern built-in valve with chromed cap*  
*LLave para encastrar con capuchón*

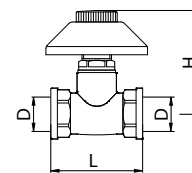

**454**

Code	Version	Size (D)	Smooth	€	D1	H	L	M	Pack
4540000400		1/2	●	<b>12,49</b>	-	85	54	-	8
4540000500		3/4	●	<b>14,44</b>	-	85	60	-	6

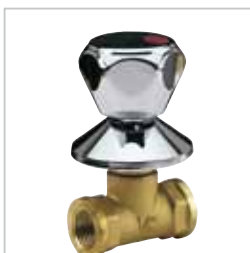

Rubinetto incasso con maniglia  
*Heavy pattern built-in valve with chromed handle*  
*LLave para encastrar con manija*

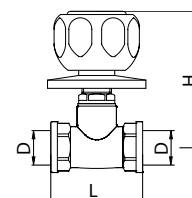

**455**

Code	Version	Size (D)	Smooth	€	D1	H	L	M	Pack
4550000400		1/2	●	<b>13,92</b>	-	90	54	-	8
4550000500		3/4	●	<b>15,88</b>	-	90	59	-	6



Filtro inclinato per acqua e gas  
*Strainer valve with filter for water and gas*  
*Filtro inclinado para agua y gas*

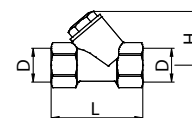

**459**

Code	Version	Size (D)	Smooth	€	D1	H	L	M	Pack
4590000400		1/2	●	<b>5,24</b>	-	40	58	-	20
4590000500		3/4	●	<b>7,33</b>	-	50	70	-	10
4590000600		1"	●	<b>12,80</b>	-	60	87	-	6
4590000700		1" 1/4	●	<b>18,73</b>	-	68	96	-	5
4590000800		1" 1/2	●	<b>23,74</b>	-	75	106	-	4
4590000900		2"	●	<b>39,29</b>	-	90	126	-	2



Rubinetto gas FF con quadro  
*Square head female-female  
 gas cock*  
*Llave gas HH con cabeza  
 cuadrada*

**470**

Code	Version	Size (D)	Smooth	€	D1	H	L	M	Pack
4700000300		3/8	●	<b>6,36</b>	-	56	46	-	12
4700000400		1/2	●	<b>6,36</b>	-	56	48	-	12
4700000500		3/4	●	<b>7,58</b>	-	69	56	-	12
4700000600		1"	●	<b>10,06</b>	-	69	68	-	6

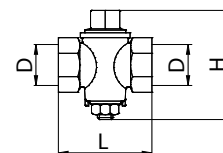

Rubinetto gas MF con quadro  
*Square head male-female gas  
 cock*  
*Llave gas MH con cabeza  
 cuadrada*

**476**

Code	Version	Size (D)	Smooth	€	D1	H	L	M	Pack
4760000700		1" 1/4	●	<b>19,24</b>	-	91	82	-	1

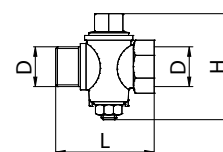

Rubinetto scarico caldaia con  
 tappo e portagomma  
*Drain cock for boiler with cap  
 and hose connection*  
*Llave de evacuación caldera  
 con tapón y portagoma*

**476C**

Code	Version	Size (D)	Smooth	€	D1	H	L	M	Pack
476C000300		3/8	●	<b>5,65</b>	-	28	74	-	1
476C000400		1/2	●	<b>5,93</b>	-	31	76	-	1
476C000500		3/4	●	<b>11,99</b>	-	38	91	-	1

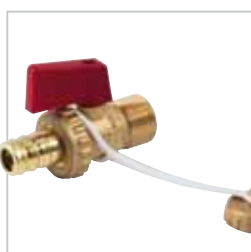
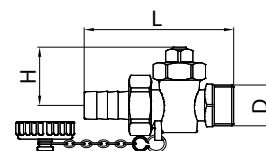

Rubinetto a sfera scarico caldaia  
 con tappo e portagomma  
*Drain ball valve for boiler with  
 cap and hose connection*  
*Llave de bola evacuación  
 caldera con tapón y portagoma*

**476CS**

Code	Version	Size (D)	Smooth	€	D1	H	L	M	Pack
476S000300		3/8	●	<b>5,56</b>	-	35	65	-	1
476S000400		1/2	●	<b>5,56</b>	-	35	65	-	1

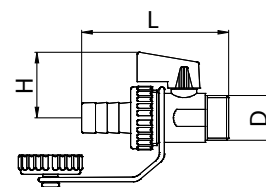



Rubinetto a sfera per serbatoio con portagomma  
*Oil barrel ball bibcock with hose connection*  
*Llave de bola para depósito con portagoma*

**479**

Code	Version	Size (D)	Smooth	€	D1	H	L	M	Pack
4790000400		1/2	●	<b>8,54</b>	-	-	102	-	8
4790000500		3/4	●	<b>9,35</b>	-	-	102	-	8

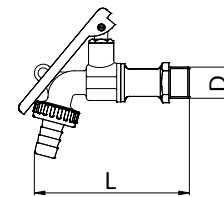

Rubinetto curvo lucido con portagomma  
*Hose bibcock, polished brass*  
*Llave curva con portagoma brillante*

**484**

Code	Version	Size (D)	Smooth	€	D1	H	L	M	Pack
4840000400		1/2	●	<b>13,07</b>	-	130	118	-	10
4840C00400		1/2	●	<b>13,75</b>	-	130	118	-	10
4840000500		3/4	●	<b>18,66</b>	-	145	122	-	5
4840C00500		3/4	●	<b>19,87</b>	-	145	122	-	5

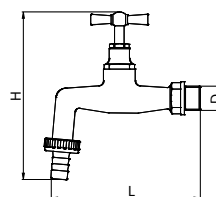

Rubinetto a sfera curvo con portagomma, maniglia a leva, tipo pesante  
*Heavy pattern ball bibcock with hose connection, lever handle*  
*Llave de bola curva con portagoma, manija de palanca, tipo pesado*

**485**

Code	Version	Size (D)	Smooth	€	D1	H	L	M	Pack
485000030F		3/8	●	<b>7,70</b>	-	-	101	84	6
485000040F		1/2	●	<b>6,99</b>	-	-	102	84	6
485000050F		3/4	●	<b>9,25</b>	-	-	115	84	6
485000060F		1"	●	<b>18,35</b>	-	-	138	88	5

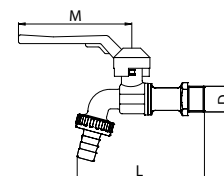

Rubinetto a sfera curvo con portagomma, maniglia a leva  
*Ball bibcock with hose connection, lever handle*  
*Llave de bola curva con portagoma, manija de palanca*

**4851**

Code	Version	Size (D)	Smooth	€	D1	H	L	M	Pack
485100040F		1/2	●	<b>6,25</b>	-	-	98	86	10

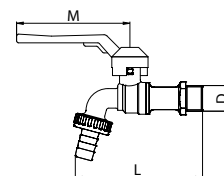



**BIANCHI F.lli S.p.a.**  
Rubinetteria

Finitura: ● Giallo/Yellow  
Smooth: ● Cromo/Chrome  
● Nichel/Nickel



Rubinetto a sfera curvo con portagomma, maniglia a farfalla, tipo pesante

*Heavy pattern ball bibcock with hose connection, T-handle*

*Llave de bola curva con portagoma, manija de mariposa, tipo pesado*

#### 487

Code	Version	Size (D)	Smooth	€	D1	H	L	M	Pack
487000040F		1/2	●	<b>6,99</b>	-	-	102	54	6
487000050F		3/4	●	<b>9,25</b>	-	-	115	54	6
487000060F		1"	●	<b>18,35</b>	-	-	138	88	6

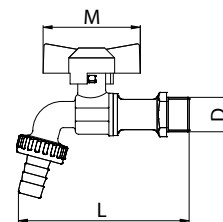

Rubinetto a sfera curvo con portagomma, maniglia a farfalla

*Ball bibcock with hose connection, T-handle*

*Llave de bola curva con portagoma, manija de mariposa*

#### 4871

Code	Version	Size (D)	Smooth	€	D1	H	L	M	Pack
487100040F		1/2	●	<b>6,25</b>	-	-	98	54	10

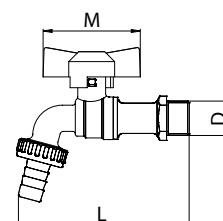

Rubinetto a squadra attacco lavatrice con rosone

*Angle ball valve for washing-machine with rosette*

*Llave de escuadra con empalme lavadora con roseta*

#### 489

Code	Version	Size (D)	Smooth	€	D1	H	L	M	Pack
489000040Q		1/2	●	<b>7,11</b>	3/4	26	42	-	10

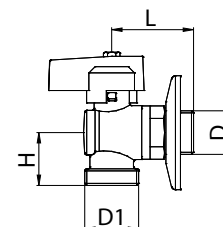

Rubinetto a squadra attacco lavatrice con rosone, modello leggero, maniglia in alluminio nichelata

*Angle ball valve for washing-machine with rosette, light pattern, nichel aluminium handle*

*Llave de escuadra empalme lavadora con roseta, modelo ligero, en manija aluminio niquelada*

#### 4891

Code	Version	Size (D)	Smooth	€	D1	H	L	M	Pack
489104040Q		1/2 x 1/2	●	<b>5,06</b>	1/2	26	39	-	1
489104050Q		1/2 x 3/4	●	<b>5,06</b>	3/4	26	39	-	1

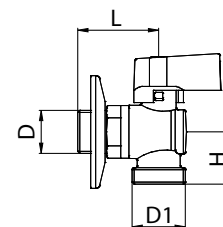





Rubinetto squadra a sfera  
attacco MM con leva in  
zama nichelata

Angle ball valve male male  
connection, nichel zama  
lever handle

Llave de escuadra de bola  
empalme MM con zama en  
manejar niquelado

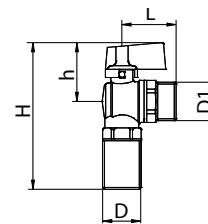

### 4892

Code	Version	Size (D)	Smooth	€	D1	H	h	L	Pack
489204040Q	-	1/2X1/2	●	<b>5,36</b>	1/2	80	32	30,5	15
489204050Q	-	1/2X3/4	●	<b>5,78</b>	3/4	80	32	32	15



Idrante da giardino

Garden cock

Boca de riego de jardin

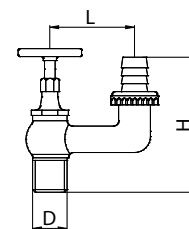

### 498

Code	Version	Size (D)	Smooth	€	D1	H	L	M	Pack
4980000400		1/2	●	<b>12,72</b>	-	82	57	-	12
4980000500		3/4	●	<b>15,63</b>	-	91	60	-	10
4980000600		1"	●	<b>25,82</b>	-	108	73	-	5



Valvola a sfera per pompa

Isolating pump ball valve

Válvula de bola para pompa

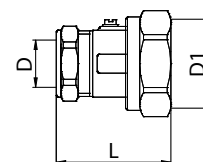

### 820

Code	Version	Size (D)	Smooth	€	D1	H	L	M	Pack
8200083200		22	●	<b>10,27</b>	1" 1/2	-	58	-	1
8200083800		28	●	<b>11,07</b>	1" 1/2	-	56	-	1



Valvola a sfera F per pompa

Isolating pump F ball valve

Válvula de bola H para pompa

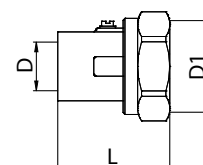

### 821

Code	Version	Size (D)	Smooth	€	D1	H	L	M	Pack
8210080600		1"	●	<b>9,28</b>	1" 1/2	-	52	-	1



**BIANCHI F.lli S.p.a.**  
Rubinetteria

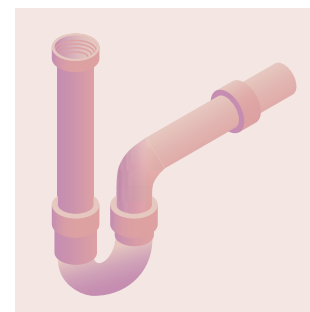
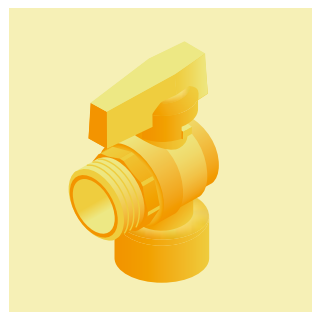
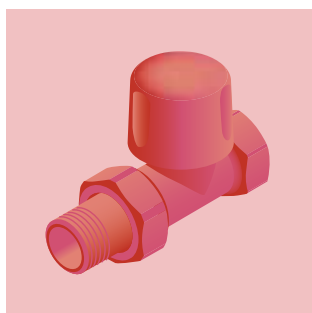
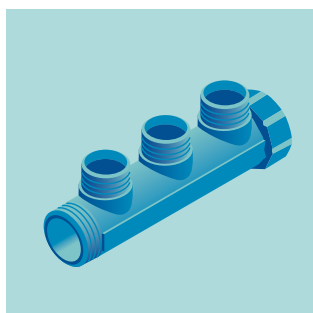

---

MADE IN ITALY  
[www.bianchifratelli.it](http://www.bianchifratelli.it)