

RACCORDI A COMPRESSIONE CON OGIVA

BRASS OLIVE COMPRESSION FITTINGS

ART. 5300.00

RACCORDO DIRITTO DOPPIO NICHELATO
 NICKEL PLATED DOUBLE STRAIGHT FITTING

CODICE CODE	MISURA SIZE	SPESSORE THICKNESS	SCATOLA BOX
530000N142000A	14 x 14	2,0	100
530000N162000A	16 x 16	2,0	100
530000N182000A	18 x 18	2,0	80
530000N202000A	20 x 20	2,0	60
530000N252500A	25 x 25	2,5	40
530000N263000A	26 x 26	3,0	40
530000N323000A	32 x 32	3,0	25

ART. 5300.02

RACCORDO DIRITTO FEMMINA NICHELATO
 NICKEL PLATED FEMALE STRAIGHT FITTING

CODICE CODE	MISURA SIZE	SPESSORE THICKNESS	SCATOLA BOX
530002N041420A	1/2" x 14	2,0	150
530002N041620A	1/2" x 16	2,0	150
530002N041820A	1/2" x 18	2,0	100
530002N042020A	1/2" x 20	2,0	80
530002N042630A	1/2" x 26	3,0	50
530002N051620A	3/4" x 16	2,0	100
530002N051820A	3/4" x 18	2,0	80
530002N052020A	3/4" x 20	2,0	80
530002N052525A	3/4" x 25	2,5	50
530002N052630A	3/4" x 26	3,0	50
530002N102525A	1" x 25	2,5	40
530002N102630A	1" x 26	3,0	40
530002N103230A	1" x 32	3,0	40

ART. 5300.01

RACCORDO DIRITTO MASCHIO NICHELATO
 NICKEL PLATED MALE STRAIGHT FITTING

CODICE CODE	MISURA SIZE	SPESSORE THICKNESS	SCATOLA BOX
530001N031620A	3/8" x 16	2,0	160
530001N041420A	1/2" x 14	2,0	160
530001N041620A	1/2" x 16	2,0	160
530001N041820A	1/2" x 18	2,0	100
530001N042020A	1/2" x 20	2,0	100
530001N042630A	1/2" x 26	2,0	50
530001N051620A	3/4" x 16	2,0	120
530001N051820A	3/4" x 18	2,0	100
530001N052020A	3/4" x 20	2,0	80
530001N052525A	3/4" x 25	2,5	50
530001N052630A	3/4" x 26	3,0	50
530001N102525A	1" x 25	2,5	50
530001N102630A	1" x 26	3,0	40
530001N103230A	1" x 32	3,0	40

ART. 5300.03

RACCORDO DIRITTO RIDOTTO NICHELATO
 NICKEL PLATED REDUCED STRAIGHT FITTING

CODICE CODE	MISURA SIZE	SPESSORE THICKNESS	SCATOLA BOX
530003N665600A	20 x 16	2,0 / 2,0	60
530003N666200A	20 x 18	2,0 / 2,0	60
530003N775600A	26 x 16	3,0 / 2,0	40
530003N776600A	26 x 20	3,0 / 2,0	40
530003N806600A	32 x 20	3,0 / 2,0	30
530003N807700A	32 x 26	3,0 / 3,0	30

RACCORDI A COMPRESSIONE CON OGIVA

BRASS OLIVE COMPRESSION FITTINGS

ART. 5300.10

RACCORDO A T NICHELATO
NICKEL PLATED TEE

CODICE CODE	MISURA SIZE	SPESSORE THICKNESS	SCATOLA BOX
530010N142000A	14 x 14 x 14	2,0	60
530010N162000A	16 x 16 x 16	2,0	60
530010N182000A	18 x 18 x 18	2,0	30
530010N202000A	20 x 20 x 20	2,0	30
530010N252500A	25 x 25 x 25	2,5	20
530010N263000A	26 x 26 x 26	3,0	20
530010N323000A	32 x 32 x 32	3,0	10

ART. 5300.12

RACCORDO A T FEMMINA NICHELATO
NICKEL PLATED FEMALE TEE

CODICE CODE	MISURA SIZE	SPESSORE THICKNESS	SCATOLA BOX
530012N041420A	14 x 1/2" x 14	2,0	50
530012N041620A	16 x 1/2" x 16	2,0	50
530012N041820A	18 x 1/2" x 18	2,0	40
530012N042020A	20 x 1/2" x 20	2,0	30
530012N051620A	16 x 3/4" x 16	2,0	30
530012N051820A	18 x 3/4" x 18	2,0	30
530012N052020A	20 x 3/4" x 20	2,0	30
530012N052525A	25 x 3/4" x 25	2,5	20
530012N052630A	26 x 3/4" x 26	3,0	20
530012N053230A	32 x 3/4" x 32	3,0	10
530012N102630A	26 x 1" x 26	3,0	20
530012N103230A	32 x 1" x 32	3,0	10

ART. 5300.11

RACCORDO A T MASCHIO NICHELATO
NICKEL PLATED MALE TEE

CODICE CODE	MISURA SIZE	SPESSORE THICKNESS	SCATOLA BOX
530011N041420A	14 x 1/2" x 14	2,0	60
530011N041620A	16 x 1/2" x 16	2,0	60
530011N041820A	18 x 1/2" x 18	2,0	40
530011N042020A	20 x 1/2" x 20	2,0	30
530011N051620A	16 x 3/4" x 16	2,0	40
530011N051820A	18 x 3/4" x 18	2,0	40
530011N052020A	20 x 3/4" x 20	2,0	30
530011N052630A	26 x 3/4" x 26	3,0	20
530011N053230A	32 x 3/4" x 32	3,0	10
530011N102630A	26 x 1" x 26	3,0	15
530011N103230A	32 x 1" x 32	3,0	10

ART. 5300.13

RACCORDO A T RIDOTTO NICHELATO
NICKEL PLATED REDUCED TEE

CODICE CODE	MISURA SIZE	SPESSORE THICKNESS	SCATOLA BOX
	1 2 3		
530013N566656A	16 x 20 x 16	2,0 / 2,0 / 2,0	30
530013N666656A	20 x 16 x 16	2,0 / 2,0 / 2,0	30
530013N666666A	20 x 16 x 20	2,0 / 2,0 / 2,0	30
530013N666656A	20 x 20 x 16	2,0 / 2,0 / 2,0	30
530013N745674A	25 x 16 x 25	2,5 / 2,0 / 2,5	20
530013N746674A	25 x 20 x 25	2,5 / 2,0 / 2,5	20
530013N775677A	26 x 16 x 26	3,0 / 2,0 / 3,0	20
530013N776677A	26 x 20 x 26	3,0 / 2,0 / 3,0	20
530013N805680A	32 x 16 x 32	3,0 / 2,0 / 3,0	10
530013N806680A	32 x 20 x 32	3,0 / 2,0 / 3,0	10
530013N807780A	32 x 26 x 32	3,0 / 3,0 / 3,0	10

"Misura" si riferisce alle dimensioni del raccordo.
"Size" refers to the fitting dimensions.

Senso di lettura per raccordi a T.
Way to read the tee (international system).

$$\begin{array}{c} 1 \\ | \\ 2 \\ | \\ 3 \end{array}$$

5300

RACCORDI A COMPRESSIONE CON OGIVA

BRASS OLIVE COMPRESSION FITTINGS

ART. 5300.18

RACCORDO A T RIDOTTO MASCHIO NICHELATO
NICKEL PLATED MALE REDUCED TEE



CODICE CODE	MISURA SIZE	SPESSORE THICKNESS	SCATOLA BOX
530018N660456A	20 x 1/2" x 16	2,0	40

ART. 5300.19

RACCORDO A T RIDOTTO FEMMINA NICHELATO
NICKEL PLATED FEMALE REDUCED TEE



CODICE CODE	MISURA SIZE	SPESSORE THICKNESS	SCATOLA BOX
530019N660456A	20 x 1/2" x 16	2,0	40
530019N660556A	20 x 3/4" x 16	2,0	40

ART. 5300.20

ANGOLO DOPPIO NICHELATO
NICKEL PLATED DOUBLE ELBOW



CODICE CODE	MISURA SIZE	SPESSORE THICKNESS	SCATOLA BOX
530020N142000A	14 x 14	2,0	80
530020N162000A	16 x 16	2,0	80
530020N182000A	18 x 18	2,0	50
530020N202000A	20 x 20	2,0	50
530020N252500A	25 x 25	2,5	20
530020N263000A	26 x 26	3,0	20
530020N323000A	32 x 32	3,0	20

ART. 5300.21

ANGOLO MASCHIO NICHELATO
NICKEL PLATED MALE ELBOW



CODICE CODE	MISURA SIZE	SPESSORE THICKNESS	SCATOLA BOX
530021N041420A	1/2" x 14	2,0	100
530021N041620A	1/2" x 16	2,0	100
530021N041820A	1/2" x 18	2,0	80
530021N042020A	1/2" x 20	2,0	60
530021N051620A	3/4" x 16	2,0	70
530021N051820A	3/4" x 18	2,0	70
530021N052020A	3/4" x 20	2,0	50
530021N052525A	3/4" x 25	2,5	30
530021N052630A	3/4" x 26	3,0	30
530021N102525A	1" x 25	2,5	30
530021N102630A	1" x 26	3,0	30
530021N103230A	1" x 32	3,0	30

ART. 5300.22

ANGOLO FEMMINA NICHELATO
NICKEL PLATED FEMALE ELBOW



CODICE CODE	MISURA SIZE	SPESSORE THICKNESS	SCATOLA BOX
530022N041420A	1/2" x 14	2,0	80
530022N041620A	1/2" x 16	2,0	80
530022N041820A	1/2" x 18	2,0	70
530022N042020A	1/2" x 20	2,0	60
530022N051620A	3/4" x 16	2,0	40
530022N051820A	3/4" x 18	2,0	40
530022N052020A	3/4" x 20	2,0	40
530022N052525A	3/4" x 25	2,5	30
530022N052630A	3/4" x 26	3,0	30
530022N102525A	1" x 25	2,5	30
530022N102630A	1" x 26	3,0	30
530022N103230A	1" x 32	3,0	20

ART. **5300.23**

ATTACCO A MURO NICHELATO CON FLANGIA 3 FORI
NICKEL PLATED WALLPLATE ELBOW WITH 3 HOLES



CODICE CODE	MISURA SIZE	SPESSORE THICKNESS	SCATOLA BOX
530023N041420A	1/2" x 14	2,0	50
530023N041620A	1/2" x 16	2,0	50
530023N041820A	1/2" x 18	2,0	50
530023N042020A	1/2" x 20	2,0	50
530023N052020A	3/4" x 20	2,0	40

ART. **5300.36**

CROCE NICHELATA
NICKEL PLATED CROSS



CODICE CODE	MISURA SIZE	SPESSORE THICKNESS	SCATOLA BOX
530036N142000A	14 x 14 x 14 x 14	2,0	60
530036N162000A	16 x 16 x 16 x 16	2,0	40
530036N182000A	18 x 18 x 18 x 18	2,0	20
530036N202000A	20 x 20 x 20 x 20	2,0	20

ART. **5300.85**

RACCORDO ADATTATORE PER TUBO RAME
ADAPTER FOR COPPER PIPE



CODICE CODE	MISURA SIZE	SPESSORE THICKNESS	SCATOLA BOX
530085N161500A	16 x 15	2,0	100

CAMPI DI APPLICAZIONE

I raccordi a compressione sono utilizzati per l'adduzione dell'acqua calda e fredda in impianti idrici sanitari e di riscaldamento.

- Temperatura massima di esercizio: 80°C.
- Temperatura minima: -20°C.
- Pressione massima di esercizio: 10 Bar.

I raccordi sono conformi alla norma **ISO 21003-3** "Sistemi di tubazioni multistrato per le installazioni di acqua calda e fredda all'interno degli edifici.

Tutte le filettature sono a norma e conformi alla **UNI EN ISO 228-1:2003** - Filettatura di tubazioni per accoppiamento non a tenuta sul filetto.

FIELDS OF APPLICATION

The compression fittings are used for hot and cold water supply in sanitary and heating installations.

- Maximum working temperature: 80°C.
- Minimum temperature: -20°C.
- Maximum operating pressure: 10 Bars.

Fittings comply with **ISO 21003-3** law. "Multilayer piping systems for hot and cold water supply installations inside buildings.

All the threads comply with **UNI EN ISO 228-1:2003** Piping thread for coupling not with tightness on the thread.

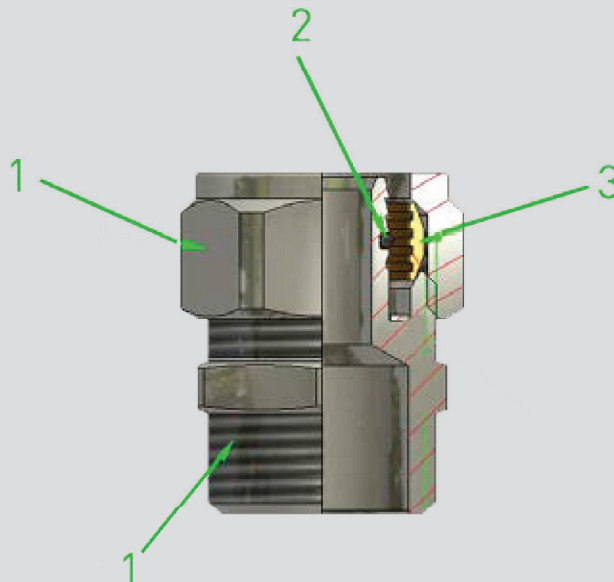

Tab. 1

MATERIALI IMPIEGATI - MATERIALS USED			
		Normativa - Regulation	Materiali - Materials
1	Stampato Hot stamped	UNI EN 12165-CW617N-CuZn40Pb2	Cu57-59 Pb1.6-2.2 Sn<0.3 Fe<0.3 Ni<0.2 Al<0.05 Zn Diff.
2	O- ring	UNI EN 681-1	EPDM PEROX 70
3	Anello (isolante) Ring (insulating)	FL8020	EPDM PEROX 70

La materia prima è composta da stampati e barre di ottone, come indicato nella Tabella 1.

The raw material is made up of hot-stamped pieces and brass bars; the pressing bush is made up of Inox steel, as shown in Table 1.

Potabilità

i materiali utilizzati sono di alta qualità e in linea con l'applicazione del Decreto Ministeriale N°174 del 06/04/2004 Regolamento concernente i materiali e gli oggetti che possono essere utilizzati negli impianti fissi di captazione, trattamento, adduzione e distribuzione delle acque destinate al consumo umano. - Norma Tedesca DIN 50930-6 Potabilità ottone - Direttiva 2002/95/EC PE.6 Allegato ROHS.

Drinkableness

the raw materials used are of high quality and comply with the Ministerial Decree N°174 dated 06/04/2004 concerning the materials and the items used in fixed installations for water collection, treatment and supply - German standard DIN 50930-6 Brass to be used for drinking water Directive 2002/95/EC PE.6 Attachment RoHS.

CLASSIFICAZIONE DELLE CONDIZIONI DI ESERCIZIO CLASSIFICATION OF SERVICE CONDITIONS Tab. 2

Classe di applicazione Application class	Temperatura di progetto Installation temperature T ^p °C	Tempo ^{b)} a T _D Time ^{b)} at T _D anni years	T _{max} T _{max} °C	Tempo a T _{max} Time at T _{max} anni years	T _{mal} T _{mal} °C	Tempo a T _{mal} Time at T _{mal} h	Campo di applicazione Field of application
1 ^{a)}	60	49	80	1	95	100	Fornitura di acqua calda Hot water supply {60 °C}
2 ^{a)}	70	49	80	1	95	100	Fornitura di acqua calda Hot water supply {70 °C}
4 ^{b)}	20	2,5	70	2,5	100	100	Riscaldamento a pavimen- to e radiatori a bassa temperatura Underfloor heating and low-temperature radiators
	plus cumulative						
	40	20					
5 ^{b)}	60	25	90	1	100	100	Radiatori ad alta temperatura High-temperature radiators
	plus cumulative						
	60	25					
	80	10					

^{a)} Un paese può scegliere la classe 1 o la classe 2 in conformità alla propria legislazione nazionale.

^{a)} A country may select either 1 or class 2 in conformity with its national regulations.

^{b)} Quando risultasse più di una temperatura di progetto per ogni classe, i tempi dovrebbero essere aggregati.

^{b)} In case more than one installation temperature appears for each class, times should be aggregated.

FILETTATURE E SERRAGGIO DADI THREADS AND NUTS TIGHTENING

Tab. 3

Ø Tubo Ø Pipe	Filetto attacco Thread coupling	N. Giri (+1/4) Turns [+1/4]
14	G 1/2"	1/2
16	G 1/2"	1/2
18	3/4"	3/4
20	3/4"	3/4
26	1"	1/2
32	M 39x1.5	1/2

ISTRUZIONI DI MONTAGGIO ASSEMBLING INSTRUCTIONS



Tagliare il tubo perpendicolarmente al suo asse utilizzando un apposito utensile taglia tubi.

Cut the pipe perpendicularly to its axis using an appropriate pipe-cutting tool.



Procedere alla calibratura e sbavatura del tubo con apposito calibro, eliminando eventuali trucioli residui.

Calibrate the pipe using special reamer, removing possible residual chips.



Inserire il dado e l'ogiva sul tubo.

Insert the nut and the gasket on the pipe.

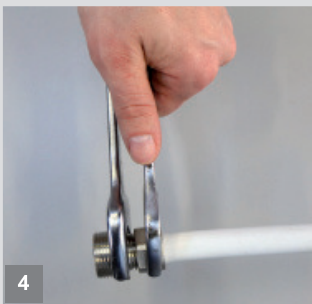

Inserire il tubo fino a battuta e avvitare il dado a mano, per quanto consentito. Con chiave esagonale avvitare il dado fino a raggiungere il numero di giri indicato nella Tabella 3.

Insert the pipe until the setback and screw by hand the nut, until allowed. With an hexagonal spanner, screw the nut until reaching the number of threads shown in Table 3.